



VESTIL MANUFACTURING CORP.

2999 North Wayne Street, P.O. Box 507, Angola, IN 46703

Telephone: (260) 665-7586 -or- Toll Free (800) 348-0868

Fax: (260) 665-1339

www.vestilmfg.com e-mail: sales@vestil.com

LM-Series and LMS-Series Fork Truck Attachments Use and Maintenance Manual



LM-HRT &
LM-HRNT



LM-OBT &
LM-OBNT



LM-1T &
LM-1NT



LMS-EBT &
LMS-EBNT



LM-EBT &
LM-EBNT

Receiving instructions:

After delivery, remove the packaging from the product. Inspect the product closely to determine whether it sustained damage during transport. If damage is discovered during the inspection, immediately record a complete description of the damage on the bill of lading. If the product is undamaged, discard the packaging.

NOTE:

The end-user is solely responsible for confirming that product design, installation, use, and maintenance comply with laws, regulations, codes, and mandatory standards applied where the product is *used*.

Table of Contents

| | |
|---------------------------------|---------|
| Signal words..... | 2 |
| Safe use recommendations..... | 2 |
| Safety Recommendations..... | 3 |
| Loading & Use Instructions..... | 23 - 25 |
| Inspections & Maintenance..... | 25 - 26 |
| Labeling diagram..... | 27 |
| Limited Warranty..... | 28 |

Table of Figures

| | |
|--|---------|
| Fig. 1: LM-1T & -1NT Exploded Parts Diagrams, Parts Lists, Center of Gravity..... | 3 - 6 |
| Fig. 2: LM-OBT & -OBNT Exploded Parts Diagrams, Parts Lists, Center of Gravity..... | 7 - 10 |
| Fig. 3: LM-HRT & -HRNT Exploded Parts Diagram, Parts Lists, Center of Gravity..... | 11 - 14 |
| Fig. 4: LM-EBT & -EBNT Exploded Parts Diagram, Parts Lists, Center of Gravity..... | 15 - 18 |
| Fig. 5: LMS-EBT-46 & -EBNT-46 Exploded Parts Diagram, Parts Lists, Centers of Gravity..... | 19 - 22 |

SIGNAL WORDS

This manual classifies personal injury risks and situations that might cause property damage with “Signal words”. Signal words indicate the seriousness of injuries that might result if a particular act or omission occurs.



Identifies a hazardous situation which, if not avoided, WILL result in DEATH or SERIOUS INJURY. Use of this signal word is limited to the most extreme situations.



Identifies a hazardous situation which, if not avoided, COULD result in DEATH or SERIOUS INJURY.



Indicates a hazardous situation which, if not avoided, COULD result in MINOR or MODERATE injury.



Identifies practices likely to result in product/property damage, such as operation that might damage the boom.

Safe Use Recommendations:

Vestil diligently strives to identify foreseeable hazards associated with the use of its products. However, material handling is dangerous and no manual can address every possible risk. The end-user ultimately is responsible for exercising sound judgment at all times.



Material handling is dangerous. Improper or careless operation might result in serious personal injuries. Acquire a copy of the latest version of ANSI B56.1, which is freely downloadable on www.ITSDF.org. Apply all relevant portions of Part II “For the User”. The following recommendations are intended to complement the guidance provided in B56.1.

- Always use this boom in compliance with all rules applied to fork truck attachment at your worksite.
- Failure to read and understand the instructions included in this manual before using or servicing the boom constitutes misuse.
- DO NOT use a damaged boom. Inspect the boom before each use according to the relevant inspection instructions that appear on p. 25-26 to determine whether the boom is in normal operating condition.
- DO NOT *contact* electrified wires with the boom.
- DO NOT use the boom if the safety chain is damaged or missing. The only purpose of the safety chain is to prevent the boom from sliding off of the forks—it is NOT intended or designed to bear the full load rating.
- DO NOT lift the boom until it is securely connected to the carriage of the fork truck with the restraint strap.
- DO NOT attempt to lift a load weighing more than the boom’s maximum rated load. Load ratings for all boom variants appear on pages 4, 6, 8, 10, 12, 14, 16, 18, 20, and 22.
- NEVER lift this boom over people.
- DO NOT permit any person to stand beneath or travel under the boom or the load.
- Inform everyone in the area that you are going to use the boom. Instruct them to stay clear of the boom and the supported load during use.
- DO NOT allow people to ride on either the boom or the load.
- DO NOT use the boom if any product label (see p. 27) is unreadable, damaged, or missing. Contact Vestil to order a replacement label(s).
- ALWAYS apply proper (fork) lift operation practices learned during your training program.
- Always make sure that shackle pins (see shackles in exploded parts diagrams, pp. 3-22) are secure before applying a load to the load hook. Tighten the screw pin before each use.
- Before raising the boom from the floor AND before attaching the load to the boom, tilt the fork lift mast away from the boom to ensure that the boom will not slide towards the tips of the forks.
- ALWAYS follow the loading and use instructions that appear on p. 23-25. Failure to properly position a load might cause a dangerous degree of load swing when the boom is elevated.
- Only use the boom to lift loads. DO NOT use the boom to drag items.
- Transport loads with the bottom of the load and the forks as low as possible.
- Drive suspended loads at low speed. Brake and turn slowly cautiously.
- DO NOT modify the boom in any way. Modifications automatically void the limited warranty (see p. 28) and might make the boom unsafe to use.

FIG. 1A: LM-1T-4k Exploded Parts Diagram & Bill of Materials

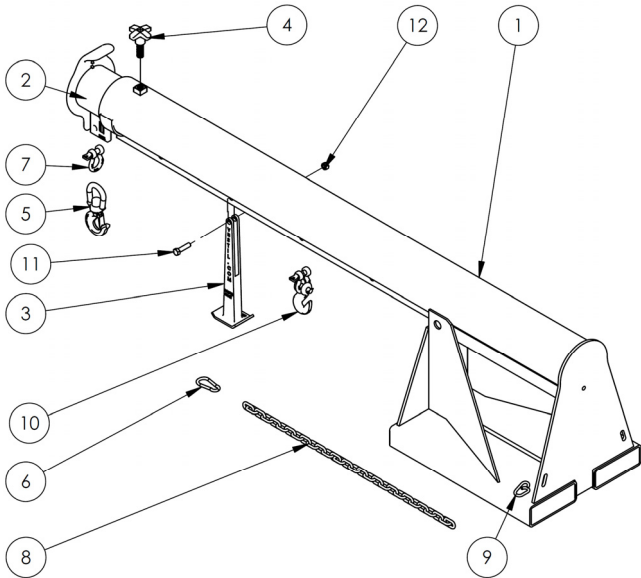

| Item No. | Part No. | Description | Quantity |
|----------|------------|---|----------|
| 1 | 08-514-176 | Weldment, frame, boom/base, 4k: LM-1T-4-11 | 1 |
| | 08-514-111 | LM-1T-4-24 | 1 |
| | 08-514-177 | LM-1T-4-30 | 1 |
| | 08-514-178 | LM-1T-4-36 | 1 |
| 2 | 08-514-261 | Weldment, inner tube | 1 |
| 3 | 08-014-134 | Frame, front support leg casting | 1 |
| 4 | 08-025-004 | X-handle, locking bolt | 1 |
| 5 | 08-145-001 | Swivel hook, 2-ton | 1 |
| 6 | 08-145-041 | ⁵ / ₁₆ " snap hook | 1 |
| 7 | 08-145-010 | ¹ / ₂ " shackle, 2-ton | 1 |
| 8 | 99-145-037 | ⁵ / ₁₆ " chain 36" long | 1 |
| 9 | 99-145-084 | Lap link | 1 |
| 10 | 99-645-019 | 2-ton hook and shackle | 1 |
| 11 | 11211 | ¹ / ₂ " -13UNC x 2" HHCS zinc-plated bolt | 1 |
| 12 | 36109 | ¹ / ₂ " - 13UNC hex nut | 1 |

FIG. 1B: LM-1T-6k Exploded Parts Diagram & Bill of Materials

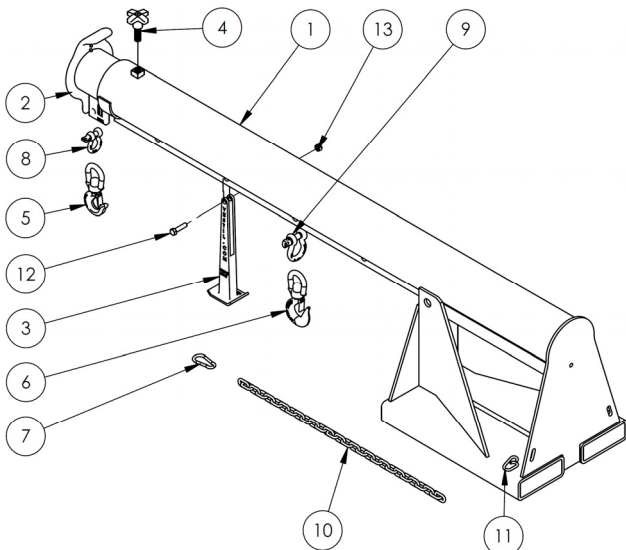

| Item No. | Part No. | Description | Quantity |
|----------|------------|---|----------|
| 1 | 08-514-179 | Weldment, frame, boom/base, 6k: LM-1T-6-11 | 1 |
| | 08-514-113 | LM-1T-6-24 | 1 |
| | 08-514-180 | LM-1T-6-30 | 1 |
| | 08-514-181 | LM-1T-6-36 | 1 |
| 2 | 08-514-261 | Weldment, inner tube | 1 |
| 3 | 08-014-134 | Frame, front support leg casting | 1 |
| 4 | 08-025-004 | X-handle, locking bolt | 1 |
| 5 | 08-145-001 | Swivel hook, 2-ton | 1 |
| 6 | 08-145-002 | Swivel hook, 3-ton | 1 |
| 7 | 08-145-041 | ⁵ / ₁₆ " snap hook | 1 |
| 8 | 08-145-010 | ¹ / ₂ " shackle, 2-ton | 1 |
| 9 | 99-145-019 | ⁵ / ₈ " 3.25-ton shackle | 1 |
| 10 | 99-145-037 | ⁵ / ₁₆ " chain 36" long | 1 |
| 11 | 99-145-084 | Lap link | 1 |
| 12 | 11211 | ¹ / ₂ " -13UNC x 2" HHCS zinc-plated bolt | 1 |
| 13 | 36109 | ¹ / ₂ " - 13UNC hex nut | 1 |

FIG. 1C: LM-1T-8k Exploded Parts Diagram & Bill of Materials

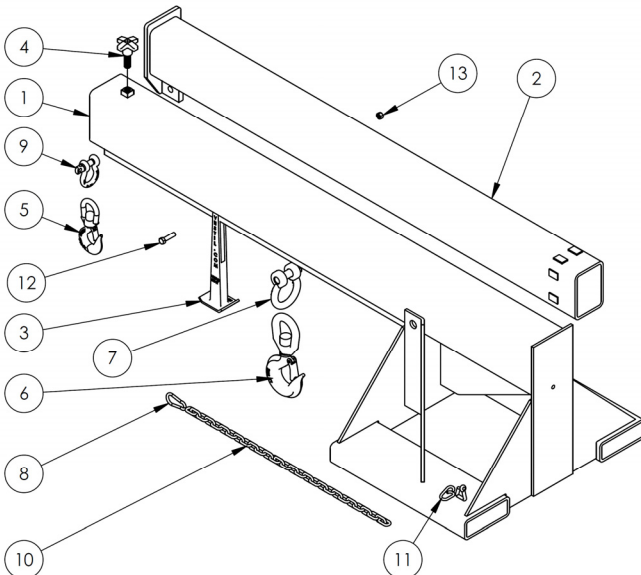

| Item No. | Part No. | Description | Quantity |
|----------|------------|---|----------|
| 1 | 08-514-115 | Weldment, frame, boom/base, 8k: LM-1T-8-24 | 1 |
| | 08-514-315 | LM-1T-8-30 | 1 |
| | 08-514-316 | LM-1T-8-36 | 1 |
| 2 | 08-514-272 | Weldment, inner tube | 1 |
| 3 | 08-014-134 | Frame, front support leg casting | 1 |
| 4 | 08-025-004 | X-handle, locking bolt | 1 |
| 5 | 08-145-002 | Swivel hook, 3-ton | 1 |
| 6 | 08-145-005 | Swivel hook, 5-ton | 1 |
| 7 | 08-145-006 | ⁷ / ₈ " 6.5-ton shackle | 1 |
| 8 | 08-145-041 | ⁵ / ₁₆ " snap hook | 1 |
| 9 | 99-145-019 | ⁵ / ₈ " 3.25-ton shackle | 1 |
| 10 | 99-145-037 | ⁵ / ₁₆ " chain 36" long | 1 |
| 11 | 99-145-084 | Lap link | 1 |
| 12 | 11211 | ¹ / ₂ " -13UNC x 2" HHCS zinc-plated bolt | 1 |
| 13 | 36110 | ¹ / ₂ " - 13UNC zinc-plated hex nut | 1 |

FIG. 1D: LM-1T- 4k, 6k & 8k Centers of Gravity and Maximum Load Ratings for Varying Load Attachment Point and Boom Extension Combinations

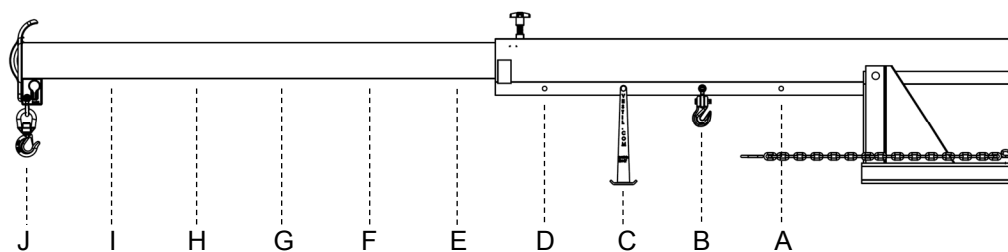

| Hook position | A | B | C | D | E | F | G | H | I | J |
|--|-------------------|-------------------|-------------------|-------------------|-------------------|-------------------|-------------------|-------------------|-------------------|-------------------|
| Distance from end of boom in inches (cm) | 36" (91cm) | 48" (122cm) | 60" (152cm) | 72" (183cm) | 84" (213cm) | 96" (244cm) | 108" (274cm) | 120" (305cm) | 132" (335cm) | 144" (366cm) |
| Maximum rated load of a load suspended from a single hook located at the corresponding "Hook position". | | | | | | | | | | |
| LM-1T-4k | 4000 lb. (1820kg) | 3750 lb. (1705kg) | 3500 lb. (1590kg) | 3250 lb. (1477kg) | 3000 lb. (1363kg) | 2750 lb. (1250kg) | 2500 lb. (1136kg) | 2250 lb. (1022kg) | 2000 lb. (909kg) | 1750 lb. (795kg) |
| LM-1T-6k | 6000 lb. (2727kg) | 5000 lb. (2272kg) | 4500 lb. (2045kg) | 4000 lb. (1820kg) | 3500 lb. (1590kg) | 3000 lb. (1363kg) | 2600 lb. (1181kg) | 2300 lb. (1045kg) | 2000 lb. (909kg) | 1800 lb. (818kg) |
| LM-1T-8k | 8000 lb. (3636kg) | 6650 lb. (3022kg) | 6000 lb. (2727kg) | 5300 lb. (2409kg) | 4650 lb. (2113kg) | 4000 lb. (1820kg) | 3500 lb. (1590kg) | 3000 lb. (1363kg) | 2600 lb. (1181kg) | 2200 lb. (1000kg) |

The center of gravity of the boom changes as boom length changes. As shown in the diagram below, the horizontal center of gravity may be located at any point from RHCG to EHCG:

- **Retracted horizontal center of gravity (RHCG):** boom fully *retracted*, and load attached at position A. RHCG is measured from the "origin point" of the above diagram (edges of the fork pockets);
- **Extended horizontal center of gravity (EHCG):** boom fully *extended* with a load attached at position J. EHCG is also measured from the "origin point" of the above diagram (edges of the fork pockets);
- All other combinations of boom extension and load position produce a horizontal center of gravity located somewhere between RHCG and EHCG.

FIG. 1E: LM-1T centers of gravity and dimensions

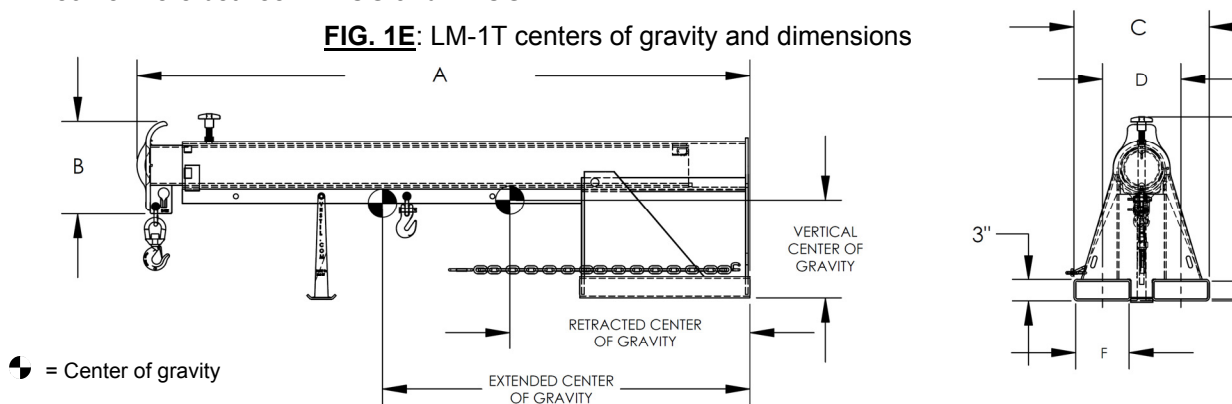

| Model | Extended horizontal center of gravity | Retracted horizontal center of gravity | Vertical center of gravity | A | B | C | D | E | F | G | Net weight |
|------------|---|--|--|---|----------------------------------|-----|-----|-----------------------------------|---------------------------------|---------------------------------|------------|
| LM-1T-4-11 | 51 ⁹ / ₁₆ in. (131.0 cm) | 33 ¹¹ / ₁₆ in. (85.6 cm) | 13 ³ / ₄ " (34.9 cm) | 86-153 ¹ / ₂ " | 13" | 19" | 11" | 25 ⁷ / ₈ " | 7 ¹ / ₂ " | 2 ¹ / ₂ " | 404.7 lb. |
| LM-1T-4-24 | 56 ³ / ₈ in. (143.2 cm) | 32 ⁵ / ₁₆ in. (82.1 cm) | 13 ⁵ / ₁₆ " (33.8 cm) | 86-153 ¹ / ₂ " | 13" | 32" | 24" | 25 ⁷ / ₈ " | 7 ¹ / ₂ " | 2 ¹ / ₂ " | 429.3 lb. |
| LM-1T-4-30 | 48 in. (121.9 cm) | 31 ³ / ₄ in. (80.6 cm) | 13 ¹ / ₁₆ " (33.2 cm) | 86-153 ¹ / ₂ " | 13" | 38" | 30" | 25 ⁷ / ₈ " | 7 ¹ / ₂ " | 2 ¹ / ₂ " | 447.4 lb. |
| LM-1T-4-36 | 46 ¹ / ₁₆ in. (117 cm) | 31 ¹ / ₁₆ in. (78.9 cm) | 12 ¹³ / ₁₆ " (32.5 cm) | 86-153 ¹ / ₂ " | 13" | 44" | 36" | 25 ⁷ / ₈ " | 7 ¹ / ₂ " | 2 ¹ / ₂ " | 465.4 lb. |
| LM-1T-6-11 | 48 in. (121.9 cm) | 31 ³ / ₄ in. (80.6 cm) | 12 ³ / ₄ " (32.4 cm) | 86-153 ¹ / ₂ " | 13" | 19" | 11" | 25 ⁷ / ₈ " | 7 ¹ / ₄ " | 2 ¹ / ₄ " | 452.7 lb. |
| LM-1T-6-24 | 46 ⁵ / ₁₆ in. (117.6 cm) | 30 ⁵ / ₈ in. (77.8 cm) | 12 ³ / ₈ " (31.4 cm) | 86-153 ¹ / ₂ " | 13" | 32" | 24" | 25 ⁷ / ₈ " | 7 ¹ / ₄ " | 2 ¹ / ₄ " | 477.4 lb. |
| LM-1T-6-30 | 44 ¹⁵ / ₁₆ in. (112.6 cm) | 30 ¹ / ₈ in. (76.5 cm) | 12 ³ / ₁₆ " (31.0 cm) | 86-153 ¹ / ₂ " | 13" | 38" | 30" | 25 ⁷ / ₈ " | 7 ¹ / ₄ " | 2 ¹ / ₄ " | 497.0 lb. |
| LM-1T-6-36 | 43 ¹³ / ₁₆ in. (111.3 cm) | 29 ⁹ / ₁₆ in. (75.1 cm) | 12" (30.5 cm) | 86-153 ¹ / ₂ " | 13" | 44" | 36" | 25 ⁷ / ₈ " | 7 ¹ / ₄ " | 2 ¹ / ₄ " | 516.5 lb. |
| LM-1T-8-24 | 53 ¹ / ₄ in. (135.3 cm) | 34 ⁷ / ₁₆ in. (87.5 cm) | 13 ⁵ / ₈ " (34.6 cm) | 84 ⁵ / ₈ -149 ¹ / ₈ " | 11 ¹ / ₂ " | 32" | 24" | 26 ⁹ / ₁₆ " | 7 ¹ / ₄ " | 2 ¹ / ₄ " | 665.3 lb. |
| LM-1T-8-30 | 53 ¹ / ₄ in. (135.3 cm) | 34 ⁷ / ₁₆ in. (87.5 cm) | 13 ³ / ₈ " (34.6 cm) | 84 ⁵ / ₈ -149 ¹ / ₈ " | 11 ¹ / ₂ " | 38" | 30" | 26 ⁹ / ₁₆ " | 7 ¹ / ₄ " | 2 ¹ / ₄ " | 688.5 lb. |
| LM-1T-8-36 | 53 ¹ / ₄ in. (135.3 cm) | 34 ⁷ / ₁₆ in. (87.5 cm) | 13 ⁵ / ₈ " (34.6 cm) | 84 ⁵ / ₈ -149 ¹ / ₈ " | 11 ¹ / ₂ " | 44" | 36" | 26 ⁹ / ₁₆ " | 7 ¹ / ₄ " | 2 ¹ / ₄ " | 711.7 lb. |

FIG. 1F: LM-1NT-4k Exploded Parts Diagram & Bill of Materials

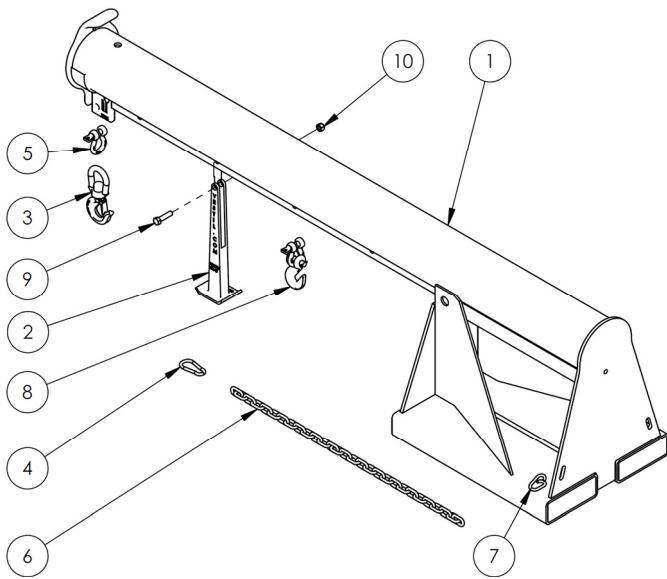

| Item No. | Part No. | Description | Quantity |
|----------|------------|---|----------|
| 1 | 08-514-319 | Weldment, frame, boom/base: LM-1NT-4-11 | 1 |
| | 08-514-128 | LM-1NT-4-24 | 1 |
| | 08-514-320 | LM-1NT-4-30 | 1 |
| | 08-514-321 | LM-1NT-4-36 | 1 |
| 2 | 08-014-134 | Frame, front support leg casting | 1 |
| 3 | 08-145-001 | Swivel hook, 2-ton | 1 |
| 4 | 08-145-041 | ⁵ / ₁₆ " snap hook | 1 |
| 5 | 08-145-010 | ¹ / ₂ " 2-ton shackle | 1 |
| 6 | 99-145-037 | ⁵ / ₁₆ " chain 36" long | 1 |
| 7 | 99-145-084 | Lap link | 1 |
| 8 | 99-645-019 | 2-ton hook and shackle | 1 |
| 9 | 11211 | ¹ / ₂ in. - 13 UNC x 2in. HHCS zinc-plated bolt | 1 |
| 10 | 36109 | ¹ / ₂ in. - 13 UNC hex nut | 1 |

FIG. 1G: LM-1NT-6k Exploded Parts Diagram & Bill of Materials

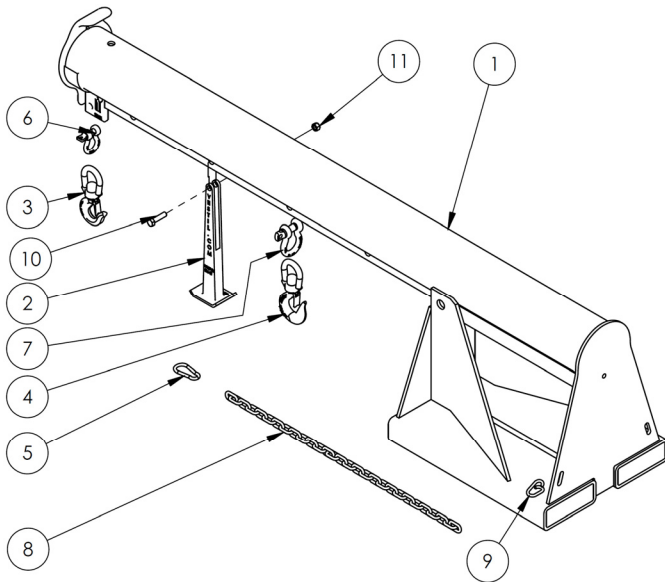

| Item No. | Part No. | Description | Quantity |
|----------|------------|---|----------|
| 1 | 08-514-322 | Weldment, frame, boom/base: LM-1NT-6-11 | 1 |
| | 08-514-129 | LM-1NT-6-24 | 1 |
| | 08-514-323 | LM-1NT-6-30 | 1 |
| | 08-514-324 | LM-1NT-6-36 | 1 |
| 2 | 08-014-134 | Frame, front support leg casting | 1 |
| 3 | 08-145-001 | Swivel hook, 2-ton | 1 |
| 4 | 08-145-002 | Swivel hook, 3-ton | 1 |
| 5 | 08-145-041 | ³ / ₁₆ " snap hook | 1 |
| 6 | 08-145-010 | ¹ / ₂ " 2-ton shackle | 1 |
| 7 | 99-145-019 | ⁵ / ₈ " 3.25-ton shackle | 1 |
| 8 | 99-145-037 | ⁵ / ₁₆ " chain 36" long | 1 |
| 9 | 99-145-084 | Lap link | 1 |
| 10 | 11211 | ¹ / ₂ in. - 13 UNC x 2in. HHCS zinc-plated bolt | 1 |
| 11 | 36109 | ¹ / ₂ in. - 13 UNC hex nut | 1 |

FIG. 1H: LM-1NT-8k Exploded Parts Diagram & Bill of Materials

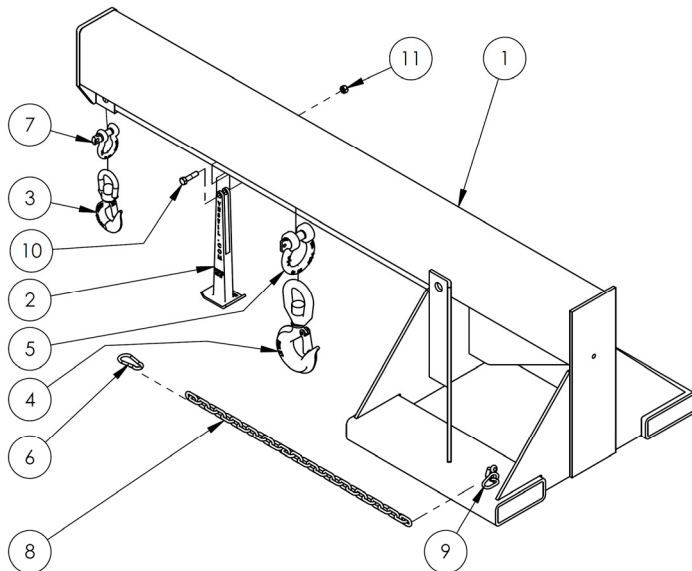

| Item No. | Part No. | Description | Quantity |
|----------|------------|---|----------|
| 1 | 08-514-130 | Weldment, frame, boom/base: LM-1NT-8-24 | 1 |
| | 08-514-317 | LM-1NT-8-30 | 1 |
| | 08-514-318 | LM-1NT-8-36 | 1 |
| 2 | 08-014-134 | Frame, front support leg casting | 1 |
| 3 | 08-145-002 | Swivel hook, 3-ton | 1 |
| 4 | 08-145-005 | Swivel hook, 5-ton | 1 |
| 5 | 08-145-006 | ⁷ / ₈ " 6.5-ton shackle | 1 |
| 6 | 08-145-041 | ⁵ / ₁₆ " snap hook | 1 |
| 7 | 99-145-019 | ⁵ / ₈ " 3.25-ton shackle | 1 |
| 8 | 99-145-037 | ⁵ / ₁₆ " chain 36" long | 1 |
| 9 | 99-145-084 | Lap link | 1 |
| 10 | 11211 | ¹ / ₂ in. - 13 UNC x 2in. HHCS zinc-plated bolt | 1 |
| 11 | 36110 | ¹ / ₂ " - 13UNC zinc-plated hex nut | 1 |

FIG. 1J: LM-1NT- 4k, 6k & 8k Centers of Gravity and Maximum Load Ratings for Varying Load Attachment Points

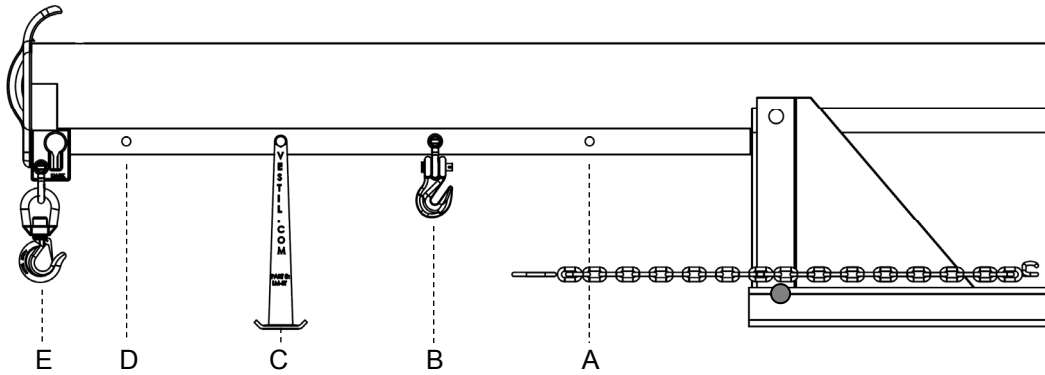

| Hook position | A | B | C | D | E |
|---|----------------------|----------------------|----------------------|----------------------|----------------------|
| Distance from end of boom in inches (cm) | 36" (91cm) | 48" (122cm) | 60" (152cm) | 72" (183cm) | 84" (213cm) |
| Maximum rated load of a load suspended from a <i>single</i> hook located at the corresponding "Hook position". | | | | | |
| LM-1NT-4k | 4000 lb. (1820kg) | 3750 lb. (1705kg) | 3500 lb. (1590kg) | 3250 lb. (1477kg) | 3000 lb. (1363kg) |
| LM-1NT-6k | 6000 lb. (2727kg) | 5000 lb. (2272kg) | 4500 lb. (2045kg) | 4000 lb. (1820kg) | 3500 lb. (1590kg) |
| LM-1NT-8k | 8000 lb. (3636kg) | 6650 lb. (3022kg) | 6000 lb. (2727kg) | 5300 lb. (2409kg) | 4850 lb. (2205kg) |

Center of gravity has both a horizontal component and a vertical component. The *vertical* center of gravity (VCG) lies along a horizontal line above the bottom edges of the fork pockets. Similarly, the *horizontal* center of gravity (HCG) is located along a vertical line as shown in the diagram below.

FIG. 1K: LM-1NT centers of gravity and dimensions

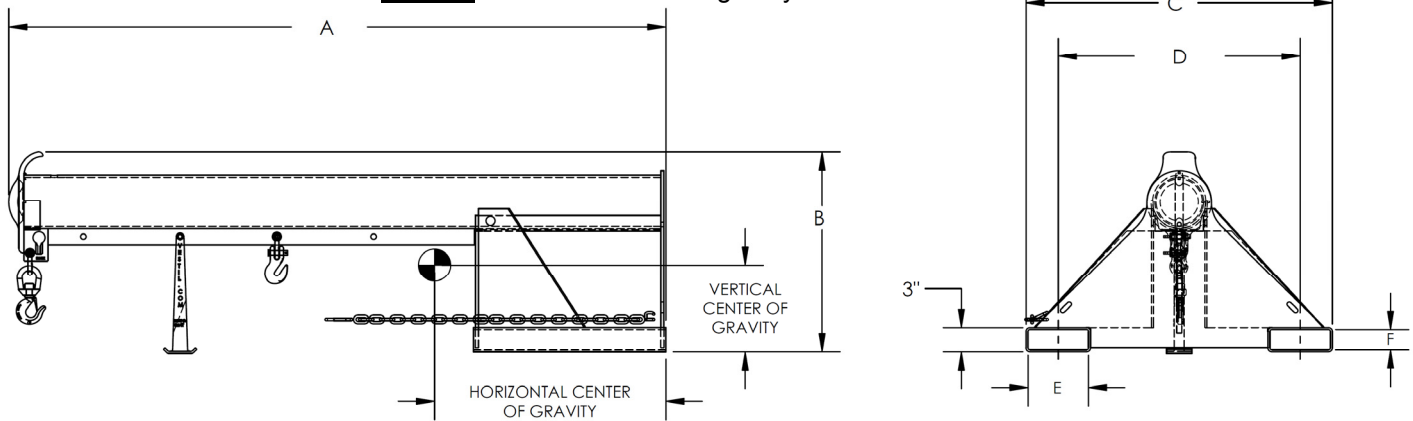

| Model | Horizontal center of gravity | Vertical center of gravity | A | B | C | D | E | F | Net weight |
|-------------|--|--|----------------------------------|------------------------------------|-----|-----|---------------------------------|---------------------------------|------------|
| LM-1NT-4-11 | 28 ¹¹ / ₁₆ " (72.9 cm) | 10 ¹³ / ₁₆ " (27.5 cm) | 81 ¹ / ₂ " | 27 ¹¹ / ₁₆ " | 19" | 11" | 7 ¹ / ₂ " | 2 ¹ / ₂ " | 309.9 lb. |
| LM-1NT-4-24 | 28 ¹¹ / ₁₆ " (72.9 cm) | 10 ¹³ / ₁₆ " (27.5 cm) | 81 ¹ / ₂ " | 24 ¹³ / ₁₆ " | 32" | 24" | 7 ¹ / ₂ " | 2 ¹ / ₂ " | 334.6 lb. |
| LM-1NT-4-30 | 28 ¹¹ / ₁₆ " (72.9 cm) | 10 ¹³ / ₁₆ " (27.5 cm) | 81 ¹ / ₂ " | 24 ¹³ / ₁₆ " | 38" | 30" | 7 ¹ / ₂ " | 2 ¹ / ₂ " | 352.6 lb. |
| LM-1NT-4-36 | 28 ¹¹ / ₁₆ " (72.9 cm) | 10 ¹³ / ₁₆ " (27.5 cm) | 81 ¹ / ₂ " | 24 ¹³ / ₁₆ " | 44" | 36" | 7 ¹ / ₂ " | 2 ¹ / ₂ " | 370.6 lb. |
| LM-1NT-6-11 | 27" (68.6cm) | 10 ¹³ / ₁₆ " (27.5 cm) | 81 ¹ / ₂ " | 24 ¹³ / ₁₆ " | 19" | 11" | 7 ¹ / ₄ " | 2 ¹ / ₄ " | 357.7 lb. |
| LM-1NT-6-24 | 27" (68.6cm) | 10 ¹³ / ₁₆ " (27.5 cm) | 81 ¹ / ₂ " | 24 ¹³ / ₁₆ " | 32" | 24" | 7 ¹ / ₄ " | 2 ¹ / ₄ " | 382.4 lb. |
| LM-1NT-6-30 | 27" (68.6cm) | 10 ¹³ / ₁₆ " (27.5 cm) | 81 ¹ / ₂ " | 24 ¹³ / ₁₆ " | 38" | 30" | 7 ¹ / ₄ " | 2 ¹ / ₄ " | 402.0 lb. |
| LM-1NT-6-36 | 27" (68.6cm) | 10 ¹³ / ₁₆ " (27.5 cm) | 81 ¹ / ₂ " | 24 ¹³ / ₁₆ " | 44" | 36" | 7 ¹ / ₄ " | 2 ¹ / ₄ " | 421.5 lb. |
| LM-1NT-8-24 | 30 ¹ / ₈ " (29.8 cm) | 11 ³ / ₄ " (29.8 cm) | 80 ¹ / ₈ " | 23 ¹ / ₂ " | 32" | 24" | 7 ¹ / ₄ " | 2 ¹ / ₄ " | 488.4 lb. |
| LM-1NT-8-30 | 30 ¹ / ₈ " (29.8 cm) | 11 ³ / ₄ " (29.8 cm) | 80 ¹ / ₈ " | 23 ¹ / ₂ " | 38" | 30" | 7 ¹ / ₄ " | 2 ¹ / ₄ " | 506.9 lb. |
| LM-1NT-8-36 | 30 ¹ / ₈ " (29.8 cm) | 11 ³ / ₄ " (29.8 cm) | 80 ¹ / ₈ " | 23 ¹ / ₂ " | 44" | 36" | 7 ¹ / ₄ " | 2 ¹ / ₄ " | 525.4 lb. |

FIG. 2A: LM-OBT-4k Exploded Parts Diagram & Bill of Materials

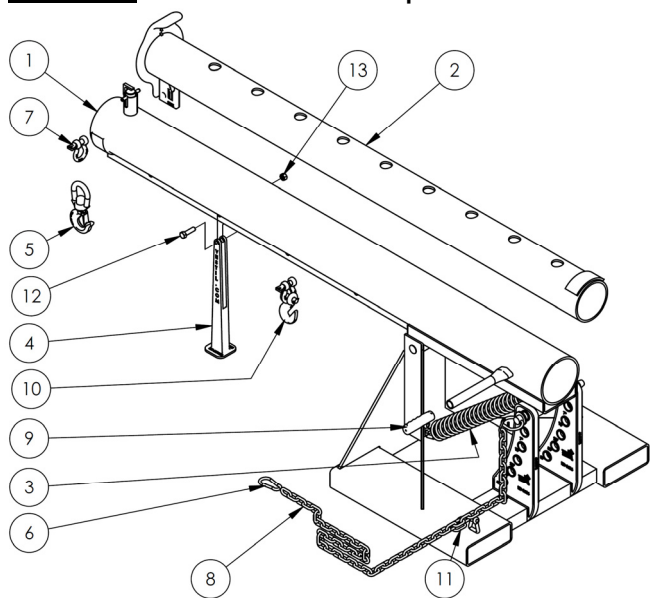

| Item No. | Part No. | Description | Quantity |
|----------|----------------|--|----------|
| 1 | 08-514-119 | Weldment, frame, boom + base: LM-OBT-4k-24 | 1 |
| | 08-514-298 | | 1 |
| | 08-514-299 | | 1 |
| | | | |
| 2 | 08-514-293 | Weldment, inner tube | 1 |
| 3 | 01-146-006 | Spring | 1 |
| 4 | 08-014-069-001 | Frame, front supporting leg (small) casting | 1 |
| 5 | 08-145-001 | Swivel hook, 2-ton | 1 |
| 6 | 08-145-041 | ⁵ / ₁₆ " snap hook | 1 |
| 7 | 08-145-010 | ¹ / ₂ " 2-ton shackle | 1 |
| 8 | 08-645-008 | Boom chain and pin | 1 |
| 9 | 13-025-023 | ¹ / ₈ " i.d. red handle grip | 1 |
| 10 | 99-645-019 | 2-ton hook and shackle | 1 |
| 11 | 99-145-084 | Lap link | 1 |
| 12 | 11210 | ¹ / ₂ " - 13UNC x ¹ / ₄ " hex bolt | 1 |
| 13 | 36110 | ¹ / ₂ " - 13UNC zinc-plated hex nut | 1 |

FIG. 2B: LM-OBT-6k Exploded Parts Diagram & Bill of Materials

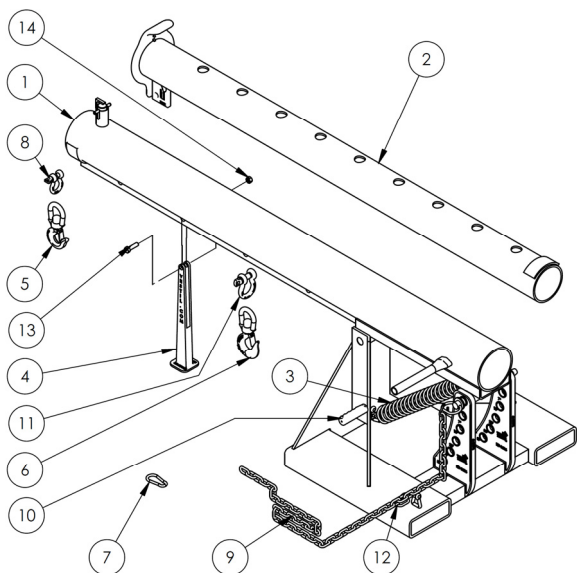

| Item No. | Part No. | Description | Quantity |
|----------|----------------|--|----------|
| 1 | 08-514-122 | Weldment, frame, boom + base: LM-OBT-6k-24 | 1 |
| | 08-514-300 | | 1 |
| | 08-514-301 | | 1 |
| | | | |
| 2 | 08-514-293 | Weldment, inner tube | 1 |
| 3 | 01-146-006 | Spring | 1 |
| 4 | 08-014-069-001 | Frame, front supporting leg (small) casting | 1 |
| 5 | 08-145-001 | Swivel hook, 2-ton | 1 |
| 6 | 08-145-002 | Swivel hook, 3-ton | 1 |
| 7 | 08-145-041 | ⁵ / ₁₆ " snap hook | 1 |
| 8 | 08-145-010 | ¹ / ₂ " 2-ton shackle | 1 |
| 9 | 08-645-008 | Boom chain and pin | 1 |
| 10 | 13-025-023 | ¹ / ₈ " i.d. red handle grip | 1 |
| 11 | 99-145-019 | 2-ton hook and shackle | 1 |
| 12 | 99-145-084 | Lap link | 1 |
| 13 | 11210 | ¹ / ₂ " - 13UNC x ¹ / ₄ " hex bolt | 1 |
| 14 | 36110 | ¹ / ₂ " - 13UNC zinc-plated hex nut | 1 |

FIG. 2C: LM-OBT-8k Exploded Parts Diagram & Bill of Materials

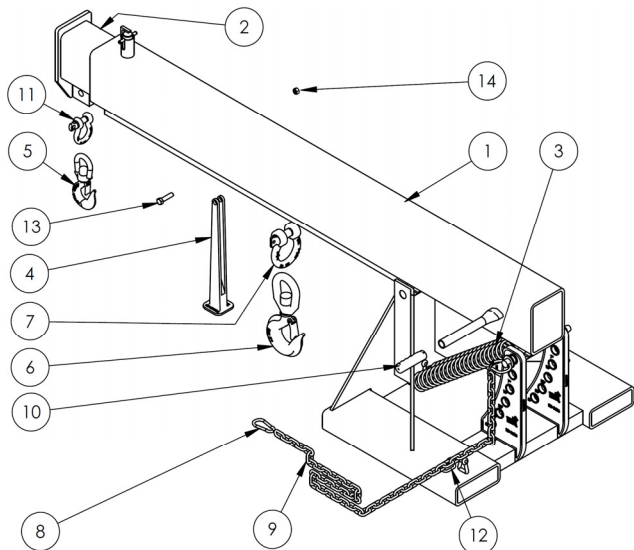

| Item No. | Part No. | Description | Quantity |
|----------|----------------|---|----------|
| 1 | 08-514-125 | Weldment, frame, boom + base: LM-OBT-8k-24 | 1 |
| | 08-514-311 | | 1 |
| | 08-514-312 | | 1 |
| | | | |
| 2 | 08-014-069-001 | Frame, front supporting leg (small) casting | 1 |
| 3 | 08-514-310 | Weldment, inner tube | 1 |
| 4 | 01-146-006 | Spring | 2 |
| 5 | 08-145-002 | Swivel hook, 3-ton | 1 |
| 6 | 08-145-005 | Swivel hook, 5-ton | 1 |
| 7 | 08-145-006 | ⁷ / ₈ " 6.5-ton shackle | 1 |
| 8 | 08-145-041 | ⁵ / ₁₆ " snap hook | 1 |
| 9 | 08-645-008 | Boom chain and pin | 1 |
| 10 | 13-025-023 | ¹ / ₈ " i.d. red handle grip | 1 |
| 11 | 99-145-019 | 2-ton hook and shackle | 1 |
| 12 | 99-145-084 | Lap link | 1 |
| 13 | 11211 | ¹ / ₂ " - 13UNC x 2" hex bolt | 1 |
| 14 | 36110 | ¹ / ₂ " - 13UNC zinc-plated hex nut | 1 |

FIG. 2D: LM-OBT- 4k, 6k & 8k Centers of Gravity and Maximum Load Ratings for Varying Load Attachment Point and Boom Extension Combinations

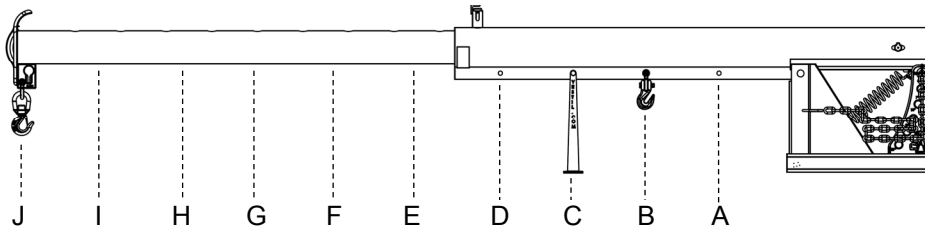

| Hook position | A | B | C | D | E | F | G | H | I | J |
|--|----------------------|----------------------|----------------------|----------------------|----------------------|----------------------|----------------------|----------------------|----------------------|----------------------|
| Distance from mast end of boom | 36" (91cm) | 48" (122cm) | 60" (152cm) | 72" (183cm) | 84" (213cm) | 96" (244cm) | 108" (274cm) | 120" (305cm) | 132" (335cm) | 144" (366cm) |
| Maximum rated load of a load suspended from a <i>single</i> hook located at the corresponding "Hook position". | | | | | | | | | | |
| LM-OBT-4k | 4000 lb. (1820kg) | 3750 lb. (1705kg) | 3500 lb. (1590kg) | 3250 lb. (1477kg) | 3000 lb. (1363kg) | 2750 lb. (1250kg) | 2500 lb. (1136kg) | 2250 lb. (1023kg) | 2000 lb. (909kg) | 1750 lb. (795kg) |
| LM-OBT-6k | 6000 lb. (2727kg) | 5000 lb. (2272kg) | 4500 lb. (2045kg) | 4000 lb. (1820kg) | 3500 lb. (1590kg) | 3000 lb. (1364kg) | 2600 lb. (1182kg) | 2300 lb. (1045kg) | 2000 lb. (909kg) | 1800 lb. (818kg) |
| LM-OBT-8k | 8000 lb. (3636kg) | 6650 lb. (3022kg) | 6000 lb. (2727kg) | 5300 lb. (2409kg) | 4650 lb. (2113kg) | 4000 lb. (1820kg) | 3500 lb. (1590kg) | 3000 lb. (1363kg) | 2600 lb. (1181kg) | 2200 lb. (1000kg) |

The center of gravity of the boom changes as boom length changes. As shown in the diagram below, the horizontal center of gravity may be located at any point from RHCG to EHCG:

- **Retracted horizontal center of gravity (RHCG):** boom fully *retracted*, and load attached at position A. RHCG is measured from the "origin point" of the above diagram (edges of the fork pockets);
- **Extended horizontal center of gravity (EHCG):** boom fully *extended* with a load attached at position J. EHCG is also measured from the "origin point" of the above diagram (edges of the fork pockets);
- All other combinations of boom extension and load position produce a horizontal center of gravity located somewhere between RHCG and EHCG.

FIG. 2E: LM-OBT centers of gravity and dimensions

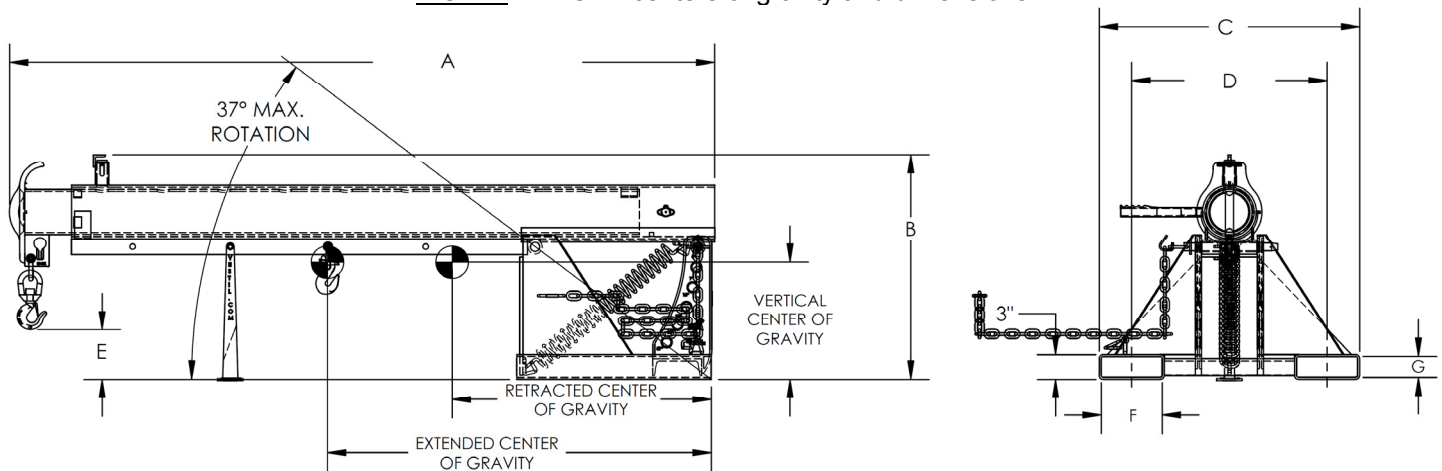

| Model | Extended horizontal center of gravity | Retracted horizontal center of gravity | Vertical center of gravity | A | B | C | D | E | F | G | Net weight |
|-------------|---|--|--|--|------------------------------------|-----|-----|---------------------------------|---------------------------------|---------------------------------|------------|
| LM-OBT-4-24 | 47 ¹ / ₈ " (119.7 cm) | 31 ¹³ / ₁₆ " (80.8 cm) | 14 ³ / ₈ " (36.5 cm) | 86 ⁵ / ₈ "-146 ⁵ / ₈ " | 27 ¹¹ / ₁₆ " | 32" | 24" | 6" | 7 ¹ / ₂ " | 2 ¹ / ₂ " | 433.9 lb. |
| LM-OBT-4-30 | 47 ¹ / ₈ " (119.7 cm) | 31 ¹³ / ₁₆ " (80.8 cm) | 14 ³ / ₈ " (36.5 cm) | 86 ⁵ / ₈ "-146 ⁵ / ₈ " | 27 ¹¹ / ₁₆ " | 38" | 30" | 6" | 7 ¹ / ₂ " | 2 ¹ / ₂ " | 451.5 lb. |
| LM-OBT-4-36 | 47 ¹ / ₈ " (119.7 cm) | 31 ¹³ / ₁₆ " (80.8 cm) | 14 ³ / ₈ " (36.5 cm) | 86 ⁵ / ₈ "-146 ⁵ / ₈ " | 27 ¹¹ / ₁₆ " | 44" | 36" | 6" | 7 ¹ / ₂ " | 2 ¹ / ₂ " | 469.1 lb. |
| LM-OBT-6-24 | 44 ³ / ₁₆ " (119.7 cm) | 31" (78.7 cm) | 14 ³ / ₈ " (36.5 cm) | 86 ⁵ / ₈ "-146 ⁵ / ₈ " | 27 ¹¹ / ₁₆ " | 32" | 24" | 6" | 7 ¹ / ₄ " | 2 ¹ / ₄ " | 481.9 lb. |
| LM-OBT-6-30 | 44 ³ / ₁₆ " (119.7 cm) | 31" (78.7 cm) | 14 ³ / ₈ " (36.5 cm) | 86 ⁵ / ₈ "-146 ⁵ / ₈ " | 27 ¹¹ / ₁₆ " | 38" | 30" | 6" | 7 ¹ / ₄ " | 2 ¹ / ₄ " | 501.1 lb. |
| LM-OBT-6-36 | 44 ³ / ₁₆ " (119.7 cm) | 31" (78.7 cm) | 14 ³ / ₈ " (36.5 cm) | 86 ⁵ / ₈ "-146 ⁵ / ₈ " | 27 ¹¹ / ₁₆ " | 44" | 36" | 6" | 7 ¹ / ₄ " | 2 ¹ / ₄ " | 520.3 lb. |
| LM-OBT-8-24 | 51 ¹¹ / ₁₆ " (131.3 cm) | 35" (88.9 cm) | 15 ¹ / ₄ " (38.7 cm) | 85 ¹ / ₄ "-145 ¹ / ₄ " | 28 ⁷ / ₈ " | 32" | 24" | 5 ¹ / ₈ " | 7 ¹ / ₄ " | 2 ¹ / ₄ " | 665.0 lb. |
| LM-OBT-8-30 | 51 ¹¹ / ₁₆ " (131.3 cm) | 35" (88.9 cm) | 15 ¹ / ₄ " (38.7 cm) | 85 ¹ / ₄ "-145 ¹ / ₄ " | 28 ⁷ / ₈ " | 38" | 30" | 5 ¹ / ₈ " | 7 ¹ / ₄ " | 2 ¹ / ₄ " | 684.1 lb. |
| LM-OBT-8-36 | 51 ¹¹ / ₁₆ " (131.3 cm) | 35" (88.9 cm) | 15 ¹ / ₄ " (38.7 cm) | 85 ¹ / ₄ "-145 ¹ / ₄ " | 28 ⁷ / ₈ " | 44" | 36" | 5 ¹ / ₈ " | 7 ¹ / ₄ " | 2 ¹ / ₄ " | 703.3 lb. |

FIG. 2F: LM-OBNT-4k Exploded Parts Diagram & Bill of Materials

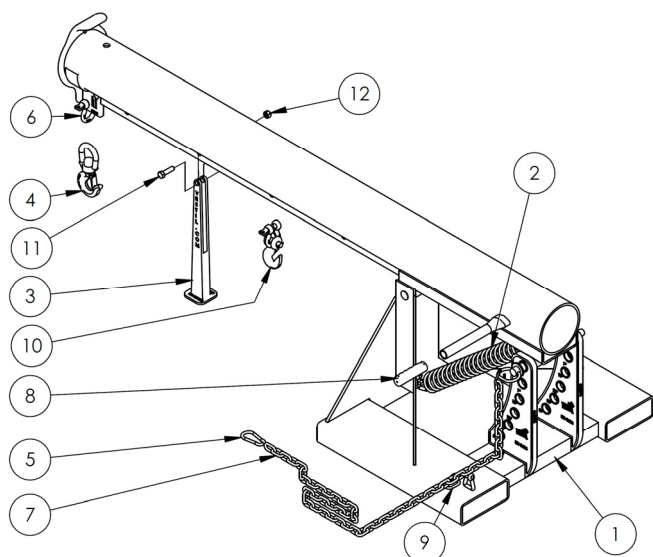

| Item No. | Part No. | Description | Quantity |
|----------|----------------|--|----------|
| 1 | 08-514-132 | Weldment, frame, boom + base | 1 |
| | 08-514-302 | LM-OBNT-4-24 | 1 |
| | 08-514-303 | LM-OBNT-4-30 | 1 |
| 2 | 01-146-006 | Spring | 1 |
| 3 | 08-014-069-001 | Frame, front support leg (small) casting | 1 |
| 4 | 08-145-001 | Swivel hook, 2-ton | 1 |
| 5 | 08-145-041 | ⁵ / ₁₆ " snap hook | 1 |
| 6 | 08-145-010 | ¹ / ₂ " 2-ton shackle | 1 |
| 7 | 08-645-008 | Assembly, boom chain and pin | 1 |
| 8 | 13-025-023 | ¹ / ₈ " inner diameter red handle grip | 1 |
| 9 | 99-145-084 | Lap link | 1 |
| 10 | 99-645-019 | 2-ton hook and shackle | 1 |
| 11 | 11210 | ¹ / ₂ " - 13UNC x 1 ³ / ₄ " hex bolt | 1 |
| 12 | 36110 | ¹ / ₂ " - 13 zinc-plated hex nut | 1 |

FIG. 2G: LM-OBNT-6k Exploded Parts Diagram & Bill of Materials

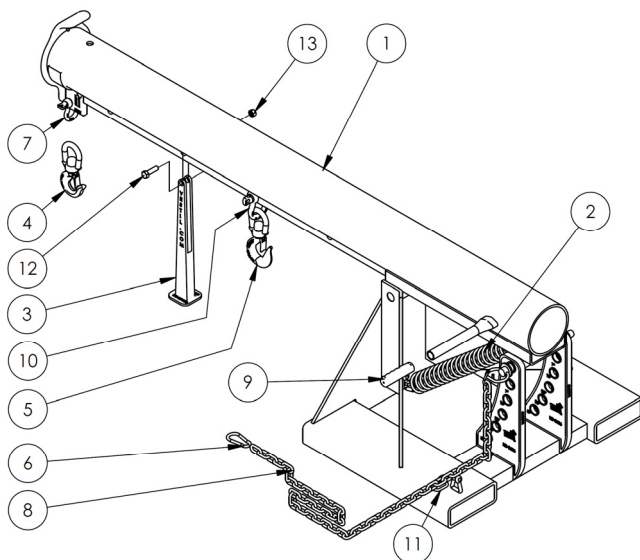

| Item No. | Part No. | Description | Quantity |
|----------|----------------|--|----------|
| 1 | 08-514-134 | Weldment, frame, boom + base | 1 |
| | 08-514-304 | LM-OBNT-6-24 | 1 |
| | 08-514-305 | LM-OBNT-6-30 | 1 |
| 2 | 01-146-006 | Spring | 1 |
| 3 | 08-014-069-001 | Frame, front support leg (small) casting | 1 |
| 4 | 08-145-001 | Swivel hook, 2-ton | 1 |
| 5 | 08-145-002 | Swivel hook, 3-ton | 1 |
| 6 | 08-145-041 | ⁵ / ₁₆ " snap hook | 1 |
| 7 | 08-145-010 | ¹ / ₂ " 2-ton shackle | 1 |
| 8 | 08-645-008 | Assembly, boom chain and pin | 1 |
| 9 | 13-025-023 | ¹ / ₈ " inner diameter red handle grip | 1 |
| 10 | 99-145-019 | ⁵ / ₈ " 3 ¹ / ₄ -ton shackle | 1 |
| 11 | 99-145-084 | Lap link | 1 |
| 12 | 11210 | ¹ / ₂ " - 13UNC x 1 ³ / ₄ " hex bolt | 1 |
| 13 | 36110 | ¹ / ₂ " - 13 zinc-plated hex nut | 1 |

FIG. 2H: LM-OBNT-8k Exploded Parts Diagram & Bill of Materials

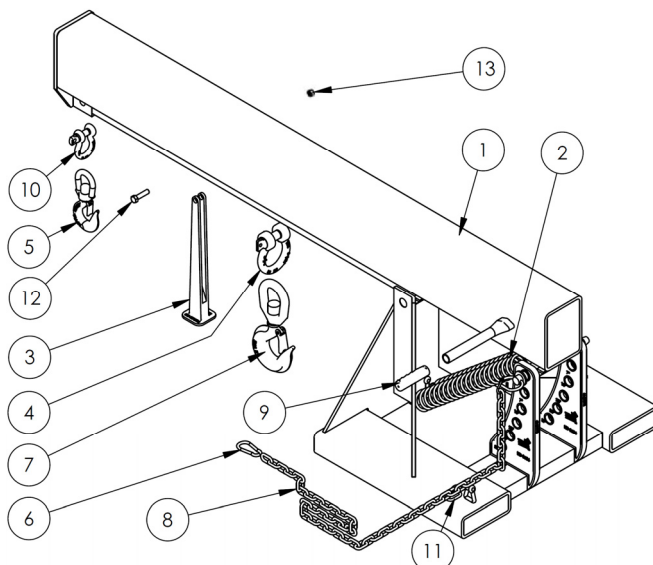

| Item No. | Part No. | Description | Quantity |
|----------|----------------|--|----------|
| 1 | 08-514-136 | Weldment, frame, boom + base | 1 |
| | 08-514-308 | LM-OBNT-8-24 | 1 |
| | 08-514-309 | LM-OBNT-8-30 | 1 |
| 2 | 01-146-006 | Spring | 2 |
| 3 | 08-014-069-001 | Frame, front support leg (small) casting | 1 |
| 4 | 08-145-006 | ¹ / ₈ " 6 ¹ / ₂ -ton shackle | 1 |
| 5 | 08-145-002 | Swivel hook, 3-ton | 1 |
| 6 | 08-145-041 | ⁵ / ₁₆ " snap hook | 1 |
| 7 | 08-145-005 | Swivel hook, 5-ton | 1 |
| 8 | 08-645-008 | Assembly, boom chain and pin | 1 |
| 9 | 13-025-023 | ¹ / ₈ " inner diameter red handle grip | 1 |
| 10 | 99-145-019 | ⁵ / ₈ " 3 ¹ / ₄ -ton shackle | 1 |
| 11 | 99-145-084 | Lap link | 1 |
| 12 | 11211 | ¹ / ₂ " - 13UNC x 2" hex bolt | 1 |
| 13 | 36110 | ¹ / ₂ " - 13 zinc-plated hex nut | 1 |

FIG. 2J: LM-OBNT- 4k, 6k & 8k Centers of Gravity and Maximum Load Ratings for Varying Load Attachment Points

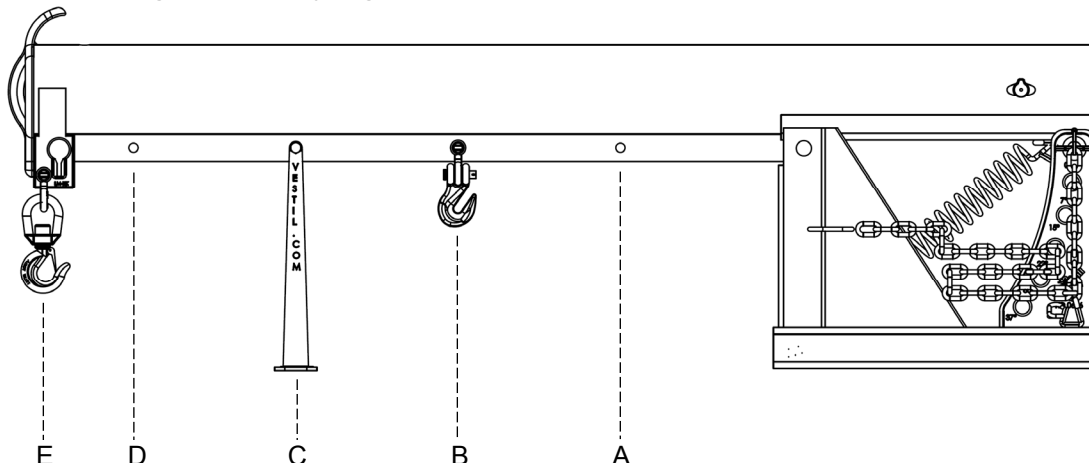

| Hook position | A | B | C | D | E |
|---|----------------------|----------------------|----------------------|----------------------|----------------------|
| Distance from end of boom in inches (cm) | 36" (91cm) | 48" (122cm) | 60" (152cm) | 72" (183cm) | 78" (198cm) |
| Maximum rated load of a load suspended from a <i>single</i> hook located at the corresponding "Hook position". | | | | | |
| LM-OBNT-4k | 4000 lb. (1820kg) | 3750 lb. (1705kg) | 3500 lb. (1590kg) | 3250 lb. (1477kg) | 3000 lb. (1363kg) |
| LM-OBNT-6k | 6000 lb. (2727kg) | 5000 lb. (2272kg) | 4500 lb. (2045kg) | 4000 lb. (1820kg) | 3500 lb. (1590kg) |
| LM-OBNT-8k | 8000 lb. (3636kg) | 6650 lb. (3022kg) | 6000 lb. (2727kg) | 5300 lb. (2409kg) | 4850 lb. (2205kg) |

Center of gravity has both a horizontal component and a vertical component. The *vertical* center of gravity (VCG) lies along a horizontal line above the bottom edges of the fork pockets. Similarly, the *horizontal* center of gravity (HCG) is located along a vertical line as shown in the diagram below.

FIG. 2K: LM-OBNT centers of gravity and dimensions

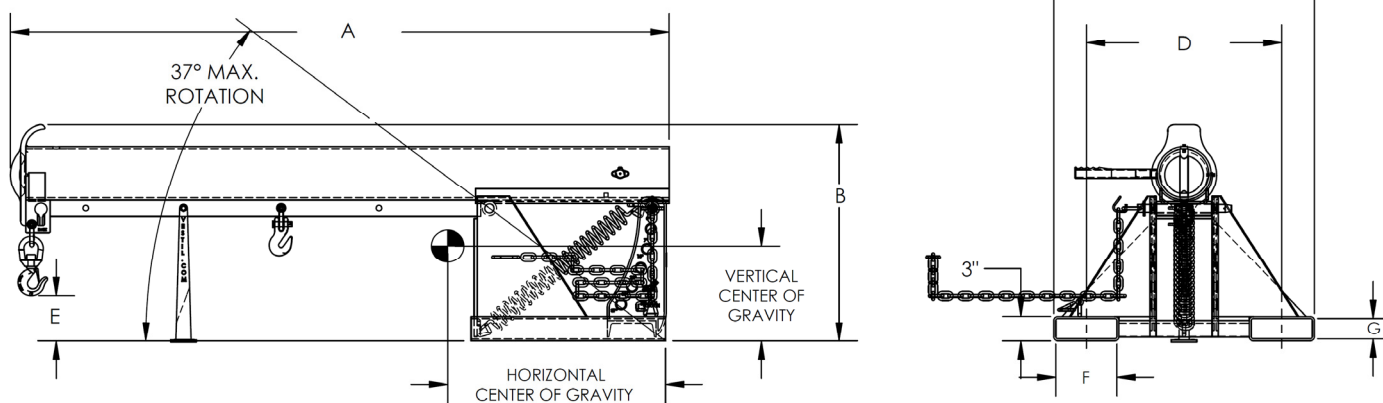

| Model | Horizontal center of gravity | Vertical center of gravity | A | B | C | D | E | F | G | Net weight |
|-------------|--|---|----------------------------------|----------------------------------|-----|-----|-----------------------------------|---------------------------------|---------------------------------|------------|
| LM-1NT-4-24 | 26 ³ / ₄ " (67.9 cm) | 11 ⁵ / ₈ " (29.5 cm) | 80 ⁷ / ₈ " | 26 ⁵ / ₈ " | 32" | 24" | 5 ¹ / ₂ " | 7 ¹ / ₂ " | 2 ¹ / ₂ " | 339.2 lb. |
| LM-1NT-4-30 | 26 ³ / ₄ " (67.9 cm) | 11 ⁵ / ₈ " (29.5 cm) | 80 ⁷ / ₈ " | 26 ⁵ / ₈ " | 38" | 30" | 5 ¹ / ₂ " | 7 ¹ / ₂ " | 2 ¹ / ₂ " | 356.9 lb. |
| LM-1NT-4-36 | 26 ³ / ₄ " (67.9 cm) | 11 ⁵ / ₈ " (29.5 cm) | 80 ⁷ / ₈ " | 26 ⁵ / ₈ " | 44" | 36" | 5 ¹ / ₂ " | 7 ¹ / ₂ " | 2 ¹ / ₂ " | 374.4 lb. |
| LM-1NT-6-24 | 26 ³ / ₄ " (67.9 cm) | 11 ⁵ / ₈ " (29.5 cm) | 80 ⁷ / ₈ " | 26 ⁵ / ₈ " | 32" | 24" | 5 ¹ / ₂ " | 7 ¹ / ₄ " | 2 ¹ / ₄ " | 387.0 lb. |
| LM-1NT-6-30 | 26 ³ / ₄ " (67.9 cm) | 11 ⁵ / ₈ " (29.5 cm) | 80 ⁷ / ₈ " | 26 ⁵ / ₈ " | 38" | 30" | 5 ¹ / ₂ " | 7 ¹ / ₄ " | 2 ¹ / ₄ " | 406.2 lb. |
| LM-1NT-6-36 | 26 ³ / ₄ " (67.9 cm) | 11 ⁵ / ₈ " (29.5 cm) | 80 ⁷ / ₈ " | 26 ⁵ / ₈ " | 44" | 36" | 5 ¹ / ₂ " | 7 ¹ / ₄ " | 2 ¹ / ₄ " | 425.4 lb. |
| LM-1NT-8-24 | 30 ¹ / ₄ " (76.8 cm) | 13 ³ / ₁₆ " (33.5 cm) | 79 ¹ / ₂ " | 25 ¹ / ₈ " | 32" | 24" | 4 ¹¹ / ₁₆ " | 7 ¹ / ₄ " | 2 ¹ / ₄ " | 490.9 lb. |
| LM-1NT-8-30 | 30 ¹ / ₄ " (76.8 cm) | 13 ³ / ₁₆ " (33.5 cm) | 79 ¹ / ₂ " | 25 ¹ / ₈ " | 38" | 30" | 4 ¹¹ / ₁₆ " | 7 ¹ / ₄ " | 2 ¹ / ₄ " | 510.0 lb. |
| LM-1NT-8-36 | 30 ¹ / ₄ " (76.8 cm) | 13 ³ / ₁₆ " (33.5 cm) | 79 ¹ / ₂ " | 25 ¹ / ₈ " | 44" | 36" | 4 ¹¹ / ₁₆ " | 7 ¹ / ₄ " | 2 ¹ / ₄ " | 521.2 lb. |

FIG. 3A: LM-HRT-4k Exploded Parts Diagram & Bill of Materials

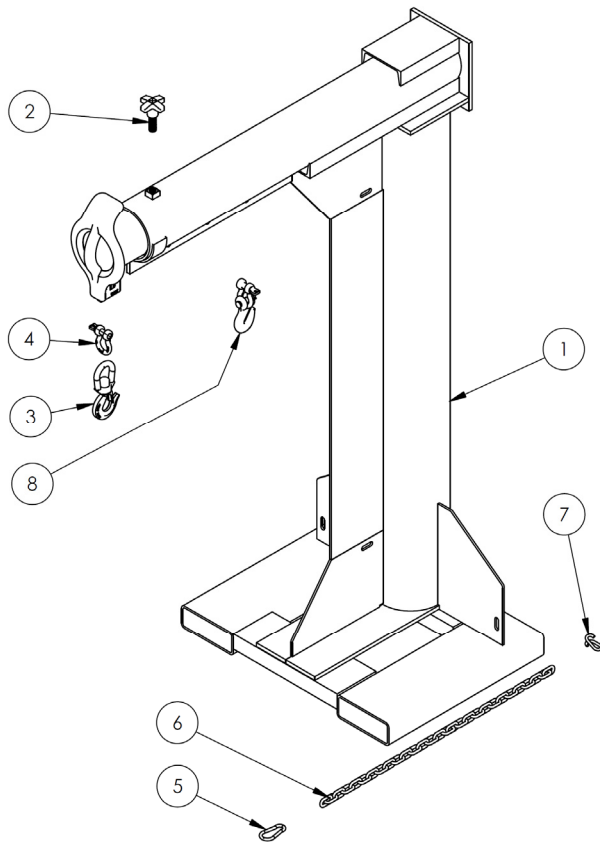

| Item No. | Part No. | Description | Quantity |
|----------|------------|-------------------------|----------|
| 1 | 08-514-005 | Assembly, frame, boom | 1 |
| | 08-514-337 | LM-HRT-4k-30 | 1 |
| | 08-514-339 | LM-HRT-4k-36 | 1 |
| 2 | 08-025-004 | X-handle, locking bolt | 1 |
| 3 | 08-145-001 | Swivel hook, 2-ton | 1 |
| 4 | 08-145-010 | 1/2 in. 2-ton shackle | 1 |
| 5 | 08-145-041 | 5/16 in. snap hook | 1 |
| 6 | 99-145-037 | 5/16 in. x 36 in. chain | 1 |
| 7 | 99-145-084 | Lap link | 1 |
| 8 | 99-645-019 | 2-ton hook and shackle | 1 |

FIG. 3B: LM-HRT-6k Exploded Parts Diagram & Bill of Materials

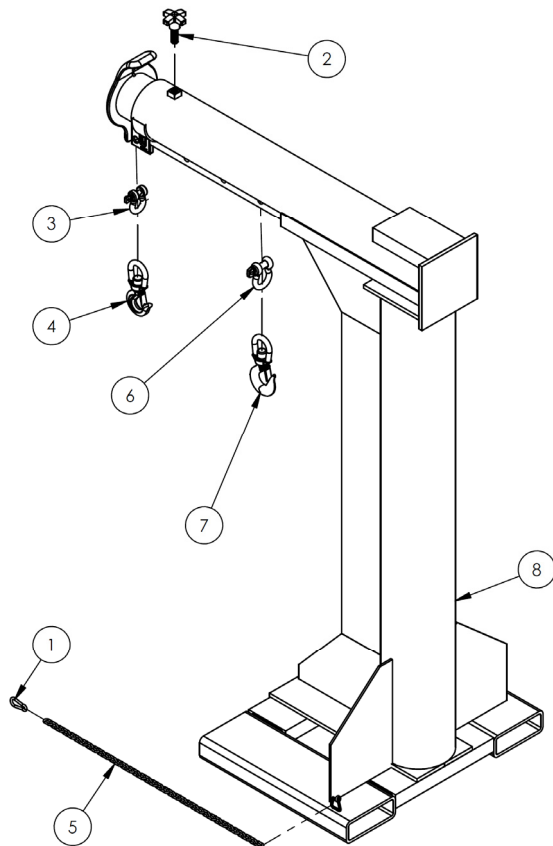

| Item No. | Part No. | Description | Quantity |
|----------|------------|---------------------------------|----------|
| 1 | 08-514-006 | Assembly, frame, boom | 1 |
| | 08-514-338 | LM-HRT-6k-30 | 1 |
| | 08-514-340 | LM-HRT-6k-36 | 1 |
| 2 | 08-025-004 | X-handle, locking bolt | 1 |
| 3 | 08-145-001 | Swivel hook, 2-ton | 1 |
| 4 | 08-145-002 | Swivel hook, 3-ton | 1 |
| 5 | 08-145-010 | 1/2" 2-ton shackle | 1 |
| 6 | 08-145-041 | 5/16" snap hook | 1 |
| 7 | 99-145-019 | 5/8" 3 1/4-ton hook and shackle | 1 |
| 8 | 99-145-037 | 5/16" x 36" chain | 1 |
| 9 | 99-145-084 | Lap link | 1 |

FIG. 3C: LM-HRT- 4k & 6k Centers of Gravity and Maximum Load Ratings for Varying Load Attachment Point and Boom Extension Combinations

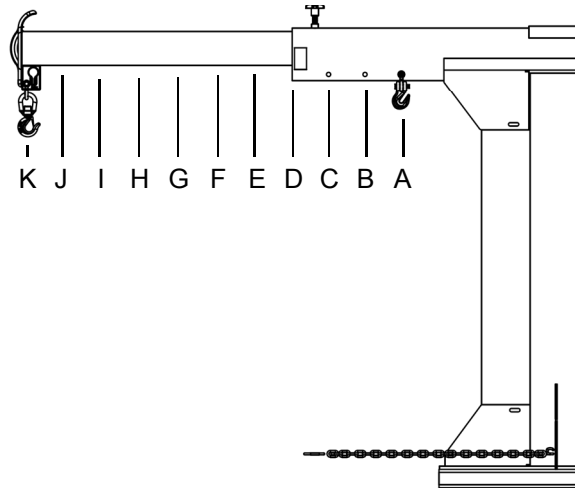

| Hook position | A | B | C | D | E | F | G | H | I | J | K |
|--|-------------------|-------------------|-------------------|-------------------|-------------------|-------------------|-------------------|-------------------|------------------|------------------|------------------|
| Distance from end of boom | 30" (76cm) | 36" (91cm) | 42" (107cm) | 48" (122cm) | 54" (137cm) | 60" (152cm) | 66" (168cm) | 72" (183cm) | 78" (198cm) | 84" (213cm) | 90" (229cm) |
| Maximum rated load of a load suspended from a single hook located at the corresponding "Hook position". | | | | | | | | | | | |
| LM-HRT-4-24 | 4000 lb. (1820kg) | 3750 lb. (1705kg) | 3500 lb. (1590kg) | 3250 lb. (1477kg) | 3000 lb. (1363kg) | 2750 lb. (1250kg) | 2500 lb. (1136kg) | 2250 lb. (1022kg) | 2000 lb. (909kg) | 1750 lb. (796kg) | 1500 lb. (682kg) |
| LM-HRT-6-24 | 6000 lb. (2727kg) | 5000 lb. (2273kg) | 4500 lb. (2046kg) | 4000 lb. (1818kg) | 3500 lb. (1591kg) | 3000 lb. (1363kg) | 2600 lb. (1182kg) | 2300 lb. (1046kg) | 2000 lb. (909kg) | 1800 lb. (818kg) | 1550 lb. (705kg) |

The center of gravity of the boom changes as boom length changes. As shown in the diagram below, the horizontal center of gravity may be located at any point from RHCG to EHCG:

- **Retracted horizontal center of gravity (RHCG):** boom fully *retracted*, and load attached at position A. RHCG is measured from the "origin point" of the above diagram (edges of the fork pockets);
- **Extended horizontal center of gravity (EHCG):** boom fully *extended* with a load attached at position J. EHCG is also measured from the "origin point" of the above diagram (edges of the fork pockets);
- All other combinations of boom extension and load position produce a horizontal center of gravity located somewhere between RHCG and EHCG.

FIG. 3D: LM-HRT centers of gravity and dimensions

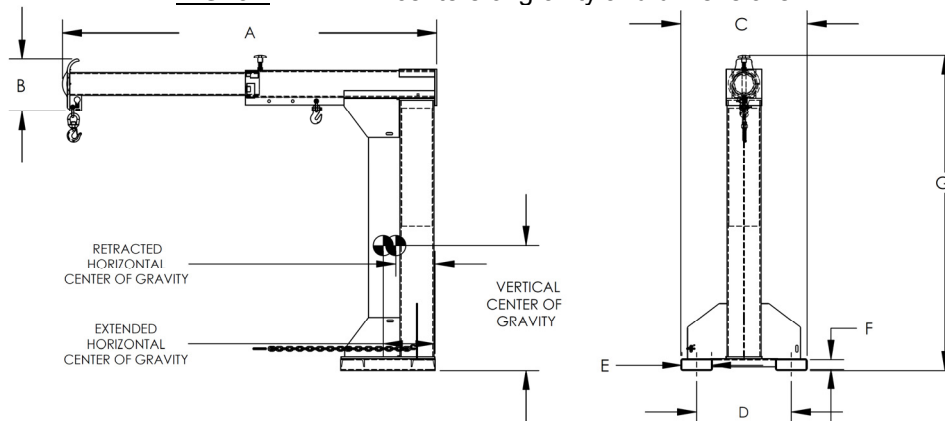

| Model | Extended horizontal center of gravity | Retracted horizontal center of gravity | Vertical center of gravity | A | B | C | D | E | F | G | Net weight |
|-------------|--|---|--|---|-----|-----|-----|---------------------------------|---------------------------------|------------------------------------|------------|
| LM-HRT-4-24 | 13 ¹ / ₈ " (33.3 cm) | 9 ¹⁵ / ₁₆ " (25.2 cm) | 31 ⁵ / ₈ " (80.3 cm) | 54 ⁷ / ₈ "-94 ⁷ / ₈ " | 13" | 32" | 24" | 7 ¹ / ₂ " | 2 ¹ / ₂ " | 79 ¹³ / ₁₆ " | 943.7 lb. |
| LM-HRT-4-30 | 13 ¹ / ₈ " (33.3 cm) | 9 ¹⁵ / ₁₆ " (25.2 cm) | 31 ⁵ / ₈ " (80.3 cm) | 54 ⁷ / ₈ "-94 ⁷ / ₈ " | 13" | 38" | 30" | 7 ¹ / ₂ " | 2 ¹ / ₂ " | 79 ¹³ / ₁₆ " | 958.9 lb. |
| LM-HRT-4-36 | 13 ¹ / ₈ " (33.3 cm) | 9 ¹⁵ / ₁₆ " (25.2 cm) | 31 ⁵ / ₈ " (80.3 cm) | 54 ⁷ / ₈ "-94 ⁷ / ₈ " | 13" | 44" | 36" | 7 ¹ / ₂ " | 2 ¹ / ₂ " | 79 ¹³ / ₁₆ " | 974.1 lb. |
| LM-HRT-6-24 | 13 ¹ / ₈ " (33.3 cm) | 10 ¹ / ₁₆ " (25.6 cm) | 30 ³ / ₄ " (78.1 cm) | 54 ⁷ / ₈ "-94 ⁷ / ₈ " | 13" | 32" | 24" | 7 ¹ / ₄ " | 2 ¹ / ₄ " | 79 ¹³ / ₁₆ " | 978.2 lb. |
| LM-HRT-6-30 | 13 ¹ / ₈ " (33.3 cm) | 10 ¹ / ₁₆ " (25.6 cm) | 30 ³ / ₄ " (78.1 cm) | 54 ⁷ / ₈ "-94 ⁷ / ₈ " | 13" | 38" | 30" | 7 ¹ / ₄ " | 2 ¹ / ₄ " | 79 ¹³ / ₁₆ " | 993.4 lb. |
| LM-HRT-6-36 | 13 ¹ / ₈ " (33.3 cm) | 10 ¹ / ₁₆ " (25.6 cm) | 30 ³ / ₄ " (78.1 cm) | 54 ⁷ / ₈ "-94 ⁷ / ₈ " | 13" | 44" | 36" | 7 ¹ / ₄ " | 2 ¹ / ₄ " | 79 ¹³ / ₁₆ " | 1008.6 lb. |

FIG. 3E: LM-HRNT-4k Exploded Parts Diagram & Bill of Materials

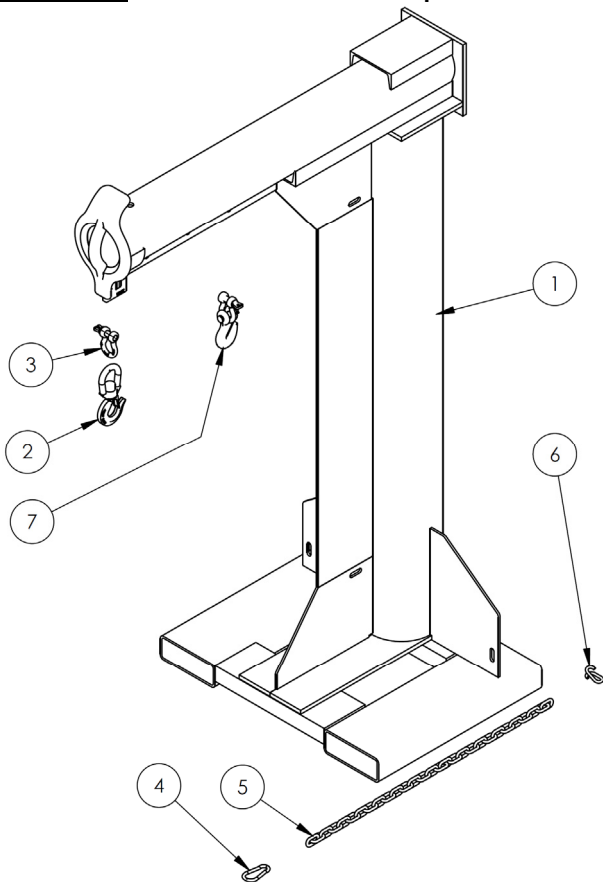

| Item No. | Part No. | Description | Quantity |
|----------|------------|--|----------|
| 1 | 08-514-007 | Frame, boom + base weldment: | 1 |
| | 08-514-341 | LM-HRNT-4-24 | 1 |
| | 08-514-343 | LM-HRNT-4-36 | 1 |
| 2 | 08-145-001 | 2-ton hook | 1 |
| 3 | 08-145-010 | Specialty hardware: 2-ton shackle | 1 |
| 4 | 08-145-041 | ⁵ / ₁₆ in. snap hook | 1 |
| 5 | 99-145-037 | ⁵ / ₁₆ in. x 36in. chain | 1 |
| 6 | 99-145-084 | Lap link | 1 |
| 7 | 99-645-019 | 2-ton hook and shackle | 1 |

FIG. 3F: LM-HRNT-6k Exploded Parts Diagram & Bill of Materials

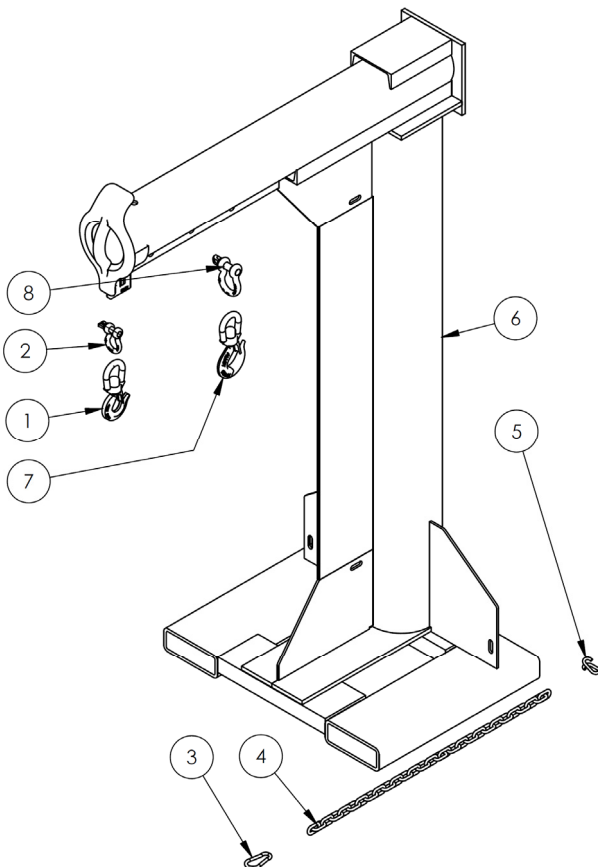

| Item No. | Part No. | Description | Quantity |
|----------|------------|--|----------|
| 1 | 08-145-001 | Swivel hook, 2-ton | 1 |
| 2 | 08-145-010 | ¹ / ₂ " 2-ton shackle | 1 |
| 3 | 08-145-041 | ⁵ / ₁₆ " snap hook | 1 |
| 4 | 99-145-037 | ⁵ / ₁₆ " chain 36" long | 1 |
| 5 | 99-145-084 | Lap Link | 1 |
| 6 | 08-514-008 | Frame, boom + base weldment: | 1 |
| | 08-514-342 | LM-HRNT-6-24 | 1 |
| | 08-514-344 | LM-HRNT-6-36 | 1 |
| 7 | 08-145-002 | Swivel hook, 3-ton | 1 |
| 8 | 99-145-019 | ⁵ / ₈ " 3 ¹ / ₄ -ton shackle | 1 |

FIG. 3G: LM-HRNT- 4k & 6k Centers of Gravity and Maximum Load Ratings for Varying Load Attachment Points

| Hook position | A | B | C | D |
|---|----------------------|----------------------|----------------------|----------------------|
| Distance from end of boom in inches (cm) | 30" (76cm) | 36" (91cm) | 42" (107cm) | 48" (122cm) |
| Maximum rated load in pounds (kg) of a load suspended from a <i>single</i> hook located at the corresponding "Hook position". | | | | |
| LM-HRNT-4k | 4000 lb. (1820kg) | 3750 lb. (1705kg) | 3500 lb. (1590kg) | 3250 lb. (1477kg) |
| LM-HRNT-6k | 6000 lb. (2727kg) | 5000 lb. (2045kg) | 4500 lb. (1727kg) | 4000 lb. (1363kg) |

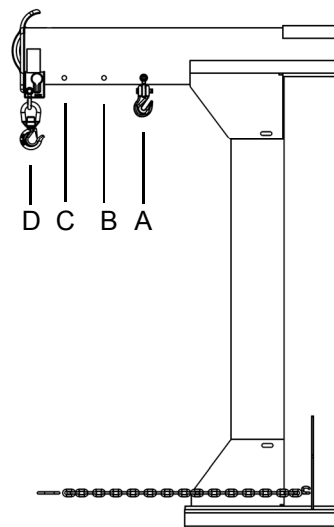

Center of gravity has both a horizontal component and a vertical component. The *vertical* center of gravity (VCG) lies along a line 38 inches (~97 cm) from the bottom edges of the fork pockets. Similarly, the *horizontal* center of gravity (HCG) is located 8 inches (~20cm) from the front edge of the vertical support.

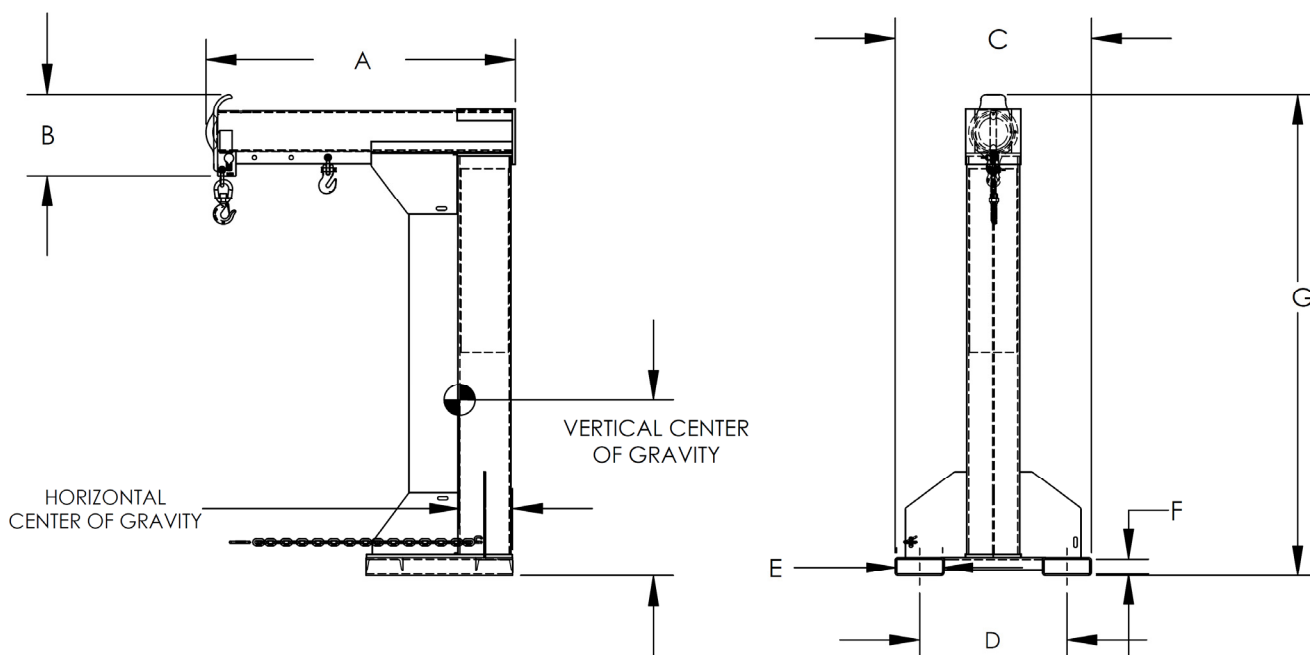

| Model | Horizontal center of gravity | Vertical center of gravity | A | B | C | D | E | F | G | Net weight |
|--------------|---|--|----------------------------------|----------------------------------|-----|-----|---------------------------------|---------------------------------|-----------------------------------|------------|
| LM-HRNT-4-24 | 8 ⁵ / ₈ " (21.9 cm) | 28 ¹¹ / ₁₆ " (72.9 cm) | 50 ³ / ₈ " | 13 ¹ / ₄ " | 32" | 24" | 7 ¹ / ₂ " | 2 ¹ / ₂ " | 78 ⁹ / ₁₆ " | 882.3 lb. |
| LM-HRNT-4-30 | 8 ⁵ / ₈ " (21.9 cm) | 28 ¹¹ / ₁₆ " (72.9 cm) | 50 ³ / ₈ " | 13 ¹ / ₄ " | 38" | 30" | 7 ¹ / ₂ " | 2 ¹ / ₂ " | 78 ⁹ / ₁₆ " | 897.5 lb. |
| LM-HRNT-4-36 | 8 ⁵ / ₈ " (21.9 cm) | 28 ¹¹ / ₁₆ " (72.9 cm) | 50 ³ / ₈ " | 13 ¹ / ₄ " | 44" | 36" | 7 ¹ / ₂ " | 2 ¹ / ₂ " | 78 ⁹ / ₁₆ " | 912.7 lb. |
| LM-HRNT-6-24 | 8 ¹³ / ₁₆ " (22.4 cm) | 27 ⁷ / ₈ " (68.9 cm) | 50 ³ / ₈ " | 13 ¹ / ₄ " | 32" | 24" | 7 ¹ / ₄ " | 2 ¹ / ₄ " | 78 ⁹ / ₁₆ " | 916.6 lb. |
| LM-HRNT-6-30 | 8 ¹³ / ₁₆ " (22.4 cm) | 27 ⁷ / ₈ " (68.9 cm) | 50 ³ / ₈ " | 13 ¹ / ₄ " | 38" | 30" | 7 ¹ / ₄ " | 2 ¹ / ₄ " | 78 ⁹ / ₁₆ " | 931.8 lb. |
| LM-HRNT-6-36 | 8 ¹³ / ₁₆ " (22.4 cm) | 27 ⁷ / ₈ " (68.9 cm) | 50 ³ / ₈ " | 13 ¹ / ₄ " | 44" | 36" | 7 ¹ / ₄ " | 2 ¹ / ₄ " | 78 ⁹ / ₁₆ " | 947.0 lb. |

FIG. 4A: LM-EBT-4k Exploded Parts Diagram & Bill of Materials

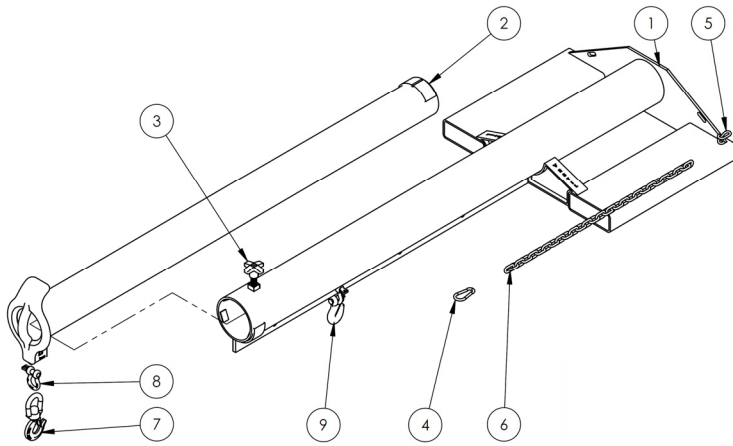

| Item No. | Part No. | Description | Quantity |
|----------|------------|---------------------------------------|----------|
| 1 | 08-514-169 | Weldment, frame, base: LM-EBT-4-11 | 1 |
| | 08-514-263 | LM-EBT-4-24 | 1 |
| | 08-514-170 | LM-EBT-4-30 | 1 |
| | 08-514-171 | LM-EBT-4-36 | 1 |
| 2 | 08-514-261 | Weldment, inner tube/boom: | 1 |
| 3 | 08-025-004 | X-handle, locking bolt | 1 |
| 4 | 08-145-041 | $\frac{5}{16}$ " snap hook | 1 |
| 5 | 99-145-084 | Lap link | 1 |
| 6 | 99-145-037 | $\frac{5}{16}$ " chain 36" long | 1 |
| 7 | 08-145-001 | Swivel hook, 2-ton | 1 |
| 8 | 08-145-010 | $\frac{1}{2}$ " 2-ton shackle | 1 |
| 9 | 99-645-019 | 2-ton hook-and-shackle | 1 |

FIG. 4B: LM-EBT-6k Exploded Parts Diagram & Bill of Materials

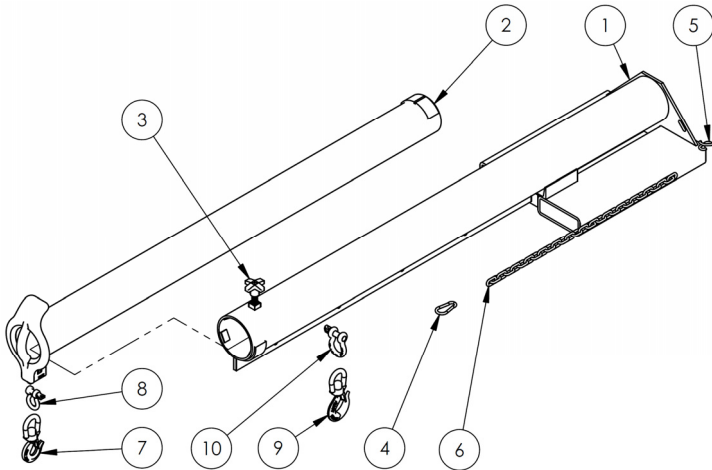

| Item No. | Part No. | Description | Quantity |
|----------|------------|--|----------|
| 1 | 08-514-172 | Weldment, frame, base: LM-EBT-6-11 | 1 |
| | 08-514-265 | LM-EBT-6-24 | 1 |
| | 08-514-173 | LM-EBT-6-30 | 1 |
| | 08-514-174 | LM-EBT-6-36 | 1 |
| 2 | 08-514-261 | Weldment, inner tube/boom: | 1 |
| 3 | 08-025-004 | X-handle, locking bolt | 1 |
| 4 | 08-145-041 | $\frac{5}{16}$ " snap hook | 1 |
| 5 | 99-145-084 | Lap link | 1 |
| 6 | 99-145-037 | $\frac{5}{16}$ " chain 36" long | 1 |
| 7 | 08-145-001 | Swivel hook, 2-ton | 1 |
| 8 | 08-145-010 | $\frac{1}{2}$ " 2-ton shackle | 1 |
| 9 | 08-145-002 | Swivel hook, 3-ton | 1 |
| 10 | 99-145-019 | $\frac{3}{8}$ " 3 $\frac{1}{4}$ -ton shackle | 1 |

FIG. 4C: LM-EBT-8k Exploded Parts Diagram & Bill of Materials

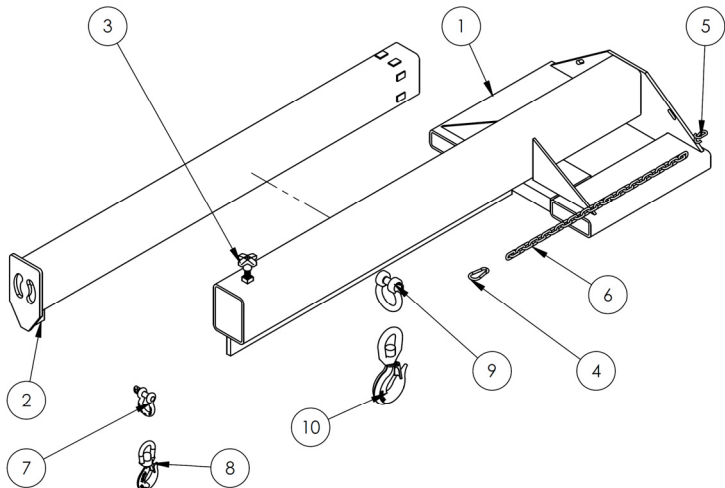

| Item No. | Part No. | Description | Quantity |
|----------|------------|--|----------|
| 1 | 08-514-274 | Weldment, frame, base: LM-EBT-8-24 | 1 |
| | 08-514-281 | LM-EBT-8-30 | 1 |
| | 08-514-282 | LM-EBT-8-36 | 1 |
| 2 | 08-514-272 | Weldment, inner tube/boom: | 1 |
| 3 | 08-025-004 | X-handle, locking bolt | 1 |
| 4 | 08-145-041 | $\frac{5}{16}$ " snap hook | 1 |
| 5 | 99-145-084 | Lap link | 1 |
| 6 | 99-145-037 | $\frac{5}{16}$ " chain 36" long | 1 |
| 7 | 99-145-019 | $\frac{5}{8}$ " 3 $\frac{1}{4}$ -ton shackle | 1 |
| 8 | 08-145-002 | Swivel hook, 3-ton | 1 |
| 9 | 08-145-006 | $\frac{7}{8}$ " 6 $\frac{1}{2}$ -ton shackle | 1 |
| 10 | 08-145-005 | Swivel hook, 5-ton | 1 |

FIG. 4D: LM-EBT – 4k, 6k & 8k Centers of Gravity and Maximum Load Ratings for Varying Load Attachment Point and Boom Extension Combinations

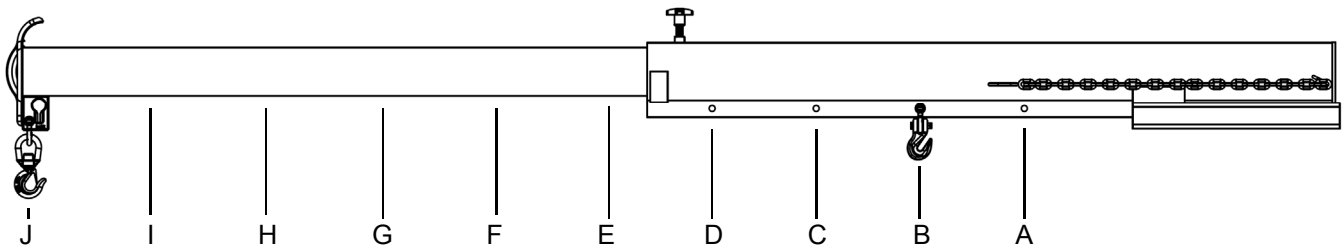

| Hook position | A | B | C | D | E | F | G | H | I | J |
|--|----------------------|----------------------|----------------------|----------------------|----------------------|----------------------|----------------------|----------------------|----------------------|----------------------|
| Distance from end of boom in inches (cm) | 36" (91cm) | 48" (122cm) | 60" (152cm) | 72" (183cm) | 84" (213cm) | 96" (244cm) | 108" (274cm) | 120" (305cm) | 132" (335cm) | 144" (366cm) |
| Maximum rated load of a load suspended from a <i>single</i> hook located at the corresponding "Hook position". | | | | | | | | | | |
| LM-EBT-4k | 4000 lb. (1820kg) | 3750 lb. (1705kg) | 3500 lb. (1590kg) | 3250 lb. (1477kg) | 3000 lb. (1363kg) | 2750 lb. (1250kg) | 2500 lb. (1136kg) | 2250 lb. (1022kg) | 2000 lb. (909kg) | 1750 lb. (796kg) |
| LM-EBT-6k | 6000 lb. (2727kg) | 5000 lb. (2273kg) | 4500 lb. (2046kg) | 4000 lb. (1818kg) | 3500 lb. (1591kg) | 3000 lb. (1363kg) | 2600 lb. (1182kg) | 2300 lb. (1046kg) | 2000 lb. (909kg) | 1800 lb. (818kg) |
| LM-EBT-8k | 8000 lb. (3636kg) | 6650 lb. (3022kg) | 6000 lb. (2727kg) | 5300 lb. (2409kg) | 4650 lb. (2113kg) | 4000 lb. (1820kg) | 3500 lb. (1590kg) | 3000 lb. (1363kg) | 2600 lb. (1181kg) | 2200 lb. (1000kg) |

The center of gravity of the boom changes as boom length changes. As shown in the diagram below, the horizontal center of gravity may be located at any point from RHCG to EHCG:

- **Retracted horizontal center of gravity (RHCG):** boom fully *retracted*, and load attached at position A. RHCG is measured from the "origin point" of the above diagram (edges of the fork pockets);
- **Extended horizontal center of gravity (EHCG):** boom fully *extended* with a load attached at position J. EHCG is also measured from the "origin point" of the above diagram (edges of the fork pockets);
- All other combinations of boom extension and load position produce a horizontal center of gravity located somewhere between RHCG and EHCG.

FIG. 4E: LM-EBT centers of gravity and dimensions

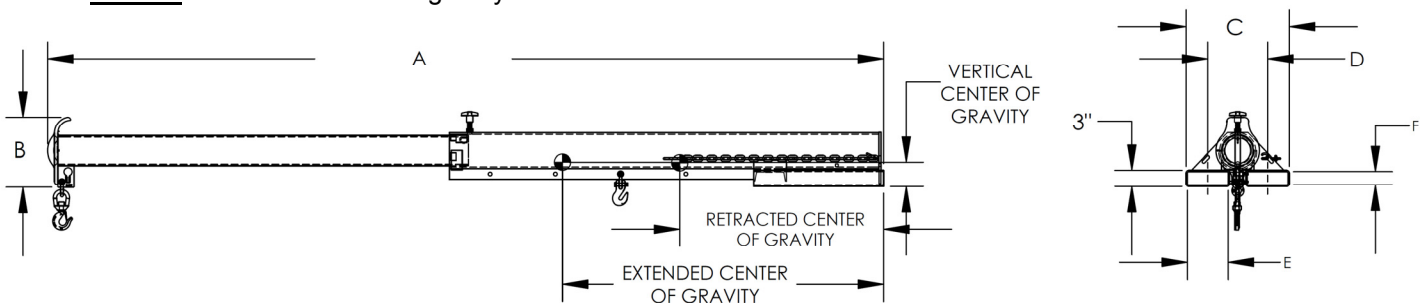

| Model | Extended horizontal center of gravity | Retracted horizontal center of gravity | Vertical center of gravity | A | B | C | D | E | F | Net weight |
|-------------|--|--|---|---|----------------------------------|-----|-----|---------------------------------|---------------------------------|------------|
| LM-EBT-4-11 | 59 ¹ / ₁₆ " (150.0 cm) | 37 ¹ / ₂ " (95.3 cm) | 4 ¹ / ₂ " (11.4 cm) | 86 ¹ / ₄ -153 ³ / ₄ " | 13" | 19" | 11" | 7 ¹ / ₂ " | 2 ¹ / ₂ " | 335.9 lb. |
| LM-EBT-4-24 | 56 ³ / ₈ " (143.2 cm) | 36" (91.4 cm) | 4 ⁷ / ₁₆ " (11.3 cm) | 86 ¹ / ₄ -153 ³ / ₄ " | 13" | 32" | 24" | 7 ¹ / ₂ " | 2 ¹ / ₂ " | 354.0 lb. |
| LM-EBT-4-30 | 55 ³ / ₈ " (140.7 cm) | 35 ³ / ₈ " (89.9 cm) | 4 ⁷ / ₁₆ " (11.3 cm) | 86 ¹ / ₄ -153 ³ / ₄ " | 13" | 38" | 30" | 7 ¹ / ₂ " | 2 ¹ / ₂ " | 367.0 lb. |
| LM-EBT-4-36 | 54 ¹ / ₈ " (137.5 cm) | 34 ¹¹ / ₁₆ " (88.1 cm) | 4 ⁷ / ₁₆ " (11.3 cm) | 86 ¹ / ₄ -153 ³ / ₄ " | 13" | 44" | 36" | 7 ¹ / ₂ " | 2 ¹ / ₂ " | 377.9 lb. |
| LM-EBT-6-11 | 54 ⁷ / ₈ " (139.4 cm) | 35 ¹ / ₈ " (89.2 cm) | 4 ¹ / ₄ " (10.8 cm) | 86 ¹ / ₄ -153 ³ / ₄ " | 13" | 19" | 11" | 7 ¹ / ₄ " | 2 ¹ / ₄ " | 368.7 lb. |
| LM-EBT-6-24 | 56 ³ / ₈ " (143.2 cm) | 36" (91.4 cm) | 4 ⁷ / ₁₆ " (11.3 cm) | 86 ¹ / ₄ -153 ³ / ₄ " | 13" | 32" | 24" | 7 ¹ / ₄ " | 2 ¹ / ₄ " | 386.8 lb. |
| LM-EBT-6-30 | 51 ¹ / ₂ " (130.8 cm) | 33 ⁵ / ₁₆ " (84.6 cm) | 4 ³ / ₁₆ " (10.6 cm) | 86 ¹ / ₄ -153 ³ / ₄ " | 13" | 38" | 30" | 7 ¹ / ₄ " | 2 ¹ / ₄ " | 403.6 lb. |
| LM-EBT-6-36 | 50 ³ / ₈ " (128.0 cm) | 32 ³ / ₄ " (83.2 cm) | 4 ³ / ₁₆ " (10.6 cm) | 86 ¹ / ₄ -153 ³ / ₄ " | 13" | 44" | 36" | 7 ¹ / ₄ " | 2 ¹ / ₄ " | 414.6 lb. |
| LM-EBT-8-24 | 57 ¹ / ₈ " (145.1 cm) | 38" (96.5 cm) | 4 ¹³ / ₁₆ " (12.2 cm) | 84 ⁷ / ₈ -149 ³ / ₈ " | 11 ¹ / ₂ " | 32" | 24" | 7 ¹ / ₄ " | 2 ¹ / ₄ " | 606.3 lb. |
| LM-EBT-8-30 | 57 ¹ / ₈ " (145.1 cm) | 38" (96.5 cm) | 4 ¹³ / ₁₆ " (12.2 cm) | 84 ⁷ / ₈ -149 ³ / ₈ " | 11 ¹ / ₂ " | 38" | 30" | 7 ¹ / ₄ " | 2 ¹ / ₄ " | 621.2 lb. |
| LM-EBT-8-36 | 57 ¹ / ₈ " (145.1 cm) | 38" (96.5 cm) | 4 ¹³ / ₁₆ " (12.2 cm) | 84 ⁷ / ₈ -149 ³ / ₈ " | 11 ¹ / ₂ " | 44" | 36" | 7 ¹ / ₄ " | 2 ¹ / ₄ " | 635.8 lb. |

FIG. 4F: LM-EBNT-4k Exploded Parts Diagram & Bill of Materials

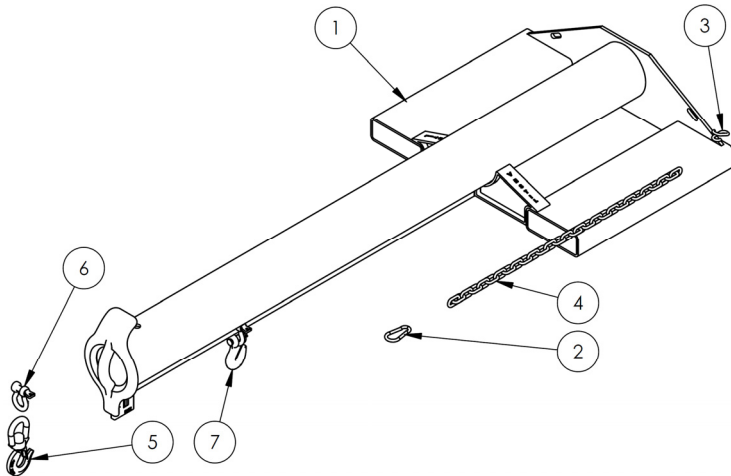

| Item no. | Part No. | Description | Quantity |
|----------|------------|--|----------|
| 1 | 08-514-287 | Weldment, frame, boom/base: LM-EBNT-4-11 | 1 |
| | 08-514-003 | LM-EBNT-4-24 | 1 |
| | 08-514-288 | LM-EBNT-4-30 | 1 |
| | 08-514-289 | LM-EBNT-4-36 | 1 |
| 2 | 08-145-041 | 5/16" snap hook | 1 |
| 3 | 99-145-084 | Lap link | 1 |
| 4 | 99-145-037 | 5/16" x 36" chain | 1 |
| 5 | 08-145-001 | Swivel hook, 2-ton | 1 |
| 6 | 08-145-010 | 1/2" 2-ton shackle | 1 |
| 7 | 99-645-019 | 2-ton hook and shackle | 1 |

FIG. 4G: LM-EBNT-6k Exploded Parts Diagram & Bill of Materials

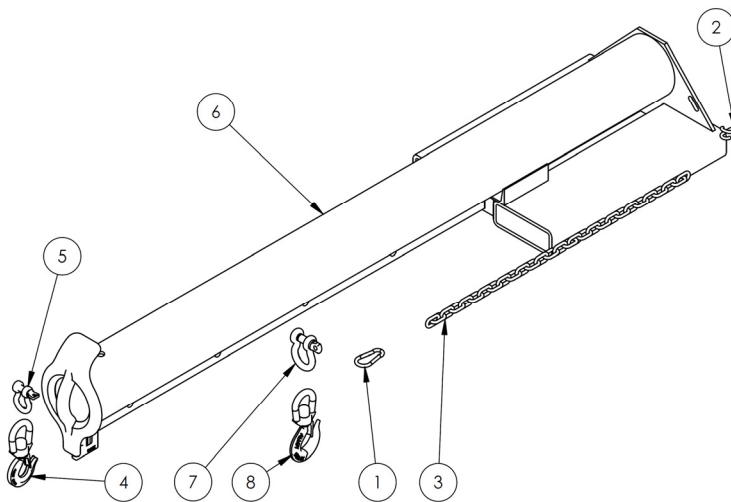

| Item no. | Part No. | Description | Quantity |
|----------|------------|--|----------|
| 1 | 08-145-041 | 5/16" snap hook | 1 |
| 2 | 99-145-084 | Lap link | 1 |
| 3 | 99-145-037 | 5/16" x 36" chain | 1 |
| 4 | 08-145-001 | Swivel hook, 2-ton | 1 |
| 5 | 08-145-010 | 1/2" 2-ton shackle | 1 |
| 6 | 08-514-290 | Weldment, frame, boom/base: LM-EBNT-6-11 | 1 |
| | 08-514-004 | LM-EBNT-6-24 | 1 |
| | 08-514-291 | LM-EBNT-6-30 | 1 |
| | 08-514-292 | LM-EBNT-6-36 | 1 |
| 7 | 99-145-019 | 5/8" 3 1/4-ton shackle | 1 |
| 8 | 08-145-002 | Swivel hook, 3-ton | 1 |

FIG. 4H: LM-EBNT-8k Exploded Parts Diagram & Bill of Materials

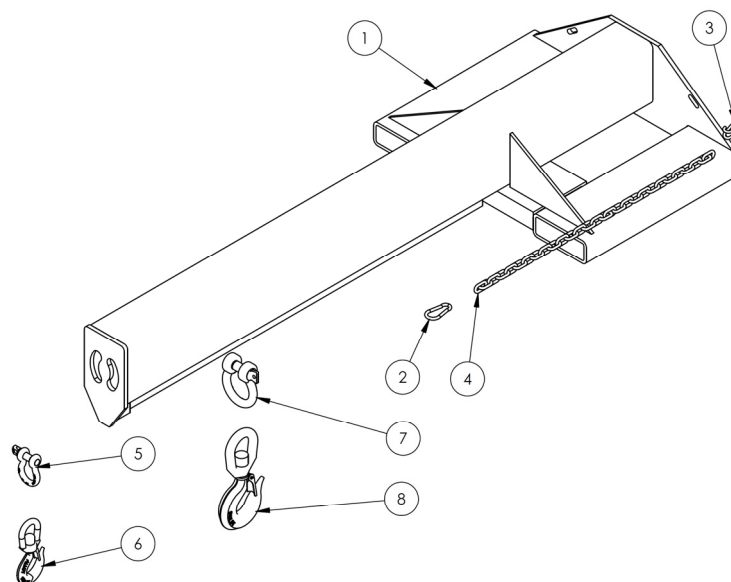

| Item no. | Part No. | Description | Quantity |
|----------|------------|--|----------|
| 1 | 08-514-191 | Weldment, frame, boom/base: LM-EBNT-8-24 | 1 |
| | 08-514-283 | LM-EBNT-8-30 | 1 |
| | 08-514-284 | LM-EBNT-8-36 | 1 |
| 2 | 08-145-041 | 5/16" snap hook | 1 |
| 3 | 99-145-084 | Lap link | 1 |
| 4 | 99-145-037 | 5/16" x 36" chain | 1 |
| 5 | 99-145-019 | 5/8" 3 1/4-ton shackle | 1 |
| 6 | 08-145-002 | Swivel hook, 3-ton | 1 |
| 7 | 08-145-006 | 1/8" 6 1/2-ton shackle | 1 |
| 8 | 08-145-005 | Swivel hook, 5-ton | 1 |

FIG. 4J: LM-EBNT- 4k, 6k & 8k Centers of Gravity and Maximum Load Ratings for Varying Load Attachment Points

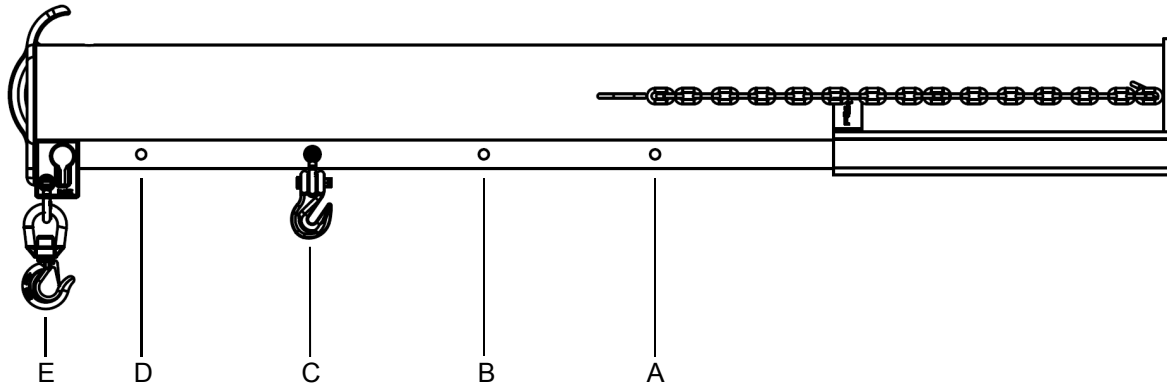

| Hook position | A | B | C | D | E |
|---|----------------------|----------------------|----------------------|----------------------|----------------------|
| Distance from end of boom in inches (cm) | 36" (91cm) | 48" (122cm) | 60" (152cm) | 72" (183cm) | 84" (213cm) |
| Maximum rated load of a load suspended from a <i>single</i> hook located at the corresponding "Hook position". | | | | | |
| LM-EBNT-4k | 4000 lb. (1820kg) | 3750 lb. (1705kg) | 3500 lb. (1590kg) | 3250 lb. (1477kg) | 3000 lb. (1364kg) |
| LM-EBNT-6k | 6000 lb. (2727kg) | 5000 lb. (2045kg) | 4500 lb. (1727kg) | 4000 lb. (1363kg) | 3500 lb. (1591kg) |
| LM-EBNT-8k | 8000 lb. (3636kg) | 6650 lb. (3023kg) | 6000 lb. (2727kg) | 5300 lb. (2409kg) | 4850 lb. (2205kg) |

Center of gravity has both a horizontal component and a vertical component. The *vertical* center of gravity (VCG) lies along a line 15 inches (~38 cm) from the bottom edges of the fork pockets. Similarly, the *horizontal* center of gravity (HCG) is located 35-7/8 inches (~91 cm) from the outer edges of the fork pockets.

FIG. 4K: LM-EBNT centers of gravity and dimensions

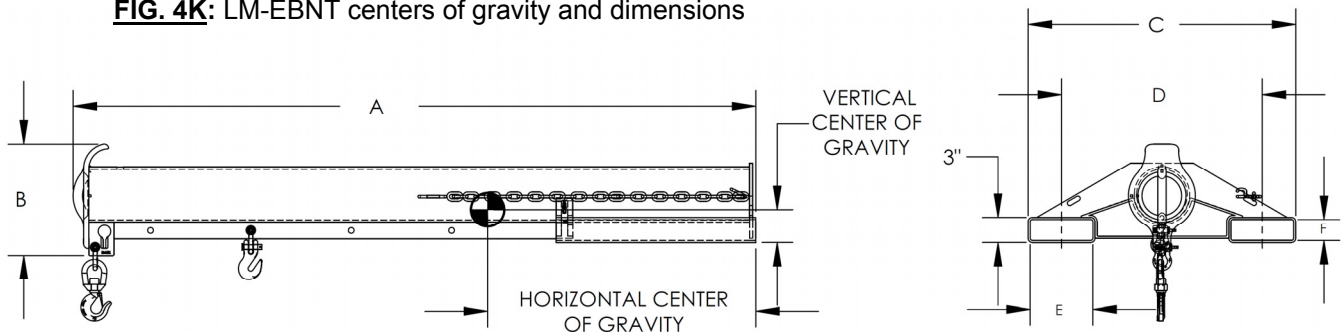

| Model | Horizontal center of gravity | Vertical center of gravity | A | B | C | D | E | F | Net weight |
|--------------|---|---|----------------------------------|-----------------------------------|-----|-----|---------------------------------|---------------------------------|------------|
| LM-EBNT-4-11 | 32 ¹ / ₁₆ " (81.4 cm) | 3 ¹⁵ / ₁₆ " (10.0 cm) | 81 ³ / ₄ " | 13 ⁵ / ₁₆ " | 19" | 11" | 7 ¹ / ₂ " | 2 ¹ / ₂ " | 239.6 lb. |
| LM-EBNT-4-24 | 28 ¹ / ₁₆ " (72.9 cm) | 3 ¹⁵ / ₁₆ " (10.0 cm) | 81 ⁵ / ₈ " | 13 ⁵ / ₁₆ " | 32" | 24" | 7 ¹ / ₂ " | 2 ¹ / ₂ " | 257.7 lb. |
| LM-EBNT-4-30 | 32 ¹ / ₁₆ " (81.4 cm) | 3 ¹⁵ / ₁₆ " (10.0 cm) | 81 ³ / ₄ " | 13 ⁵ / ₁₆ " | 38" | 30" | 7 ¹ / ₂ " | 2 ¹ / ₂ " | 270.7 lb. |
| LM-EBNT-4-36 | 32 ¹ / ₁₆ " (81.4 cm) | 3 ¹⁵ / ₁₆ " (10.0 cm) | 81 ³ / ₄ " | 13 ⁵ / ₁₆ " | 44" | 36" | 7 ¹ / ₂ " | 2 ¹ / ₂ " | 281.7 lb. |
| LM-EBNT-6-11 | 30 ¹ / ₈ " (76.5 cm) | 3 ⁵ / ₈ " (9.2 cm) | 81 ³ / ₄ " | 13 ⁵ / ₁₆ " | 19" | 11" | 7 ¹ / ₄ " | 2 ¹ / ₄ " | 276.1 lb. |
| LM-EBNT-6-24 | 30 ¹ / ₈ " (76.5 cm) | 3 ⁵ / ₈ " (9.2 cm) | 81 ⁵ / ₈ " | 13 ⁵ / ₁₆ " | 32" | 24" | 7 ¹ / ₄ " | 2 ¹ / ₄ " | 294.1 lb. |
| LM-EBNT-6-30 | 30 ¹ / ₈ " (76.5 cm) | 3 ⁵ / ₈ " (9.2 cm) | 81 ³ / ₄ " | 13 ⁵ / ₁₆ " | 38" | 30" | 7 ¹ / ₄ " | 2 ¹ / ₄ " | 307.1 lb. |
| LM-EBNT-6-36 | 30 ¹ / ₈ " (76.5 cm) | 3 ⁵ / ₈ " (9.2 cm) | 81 ³ / ₄ " | 13 ⁵ / ₁₆ " | 44" | 36" | 7 ¹ / ₄ " | 2 ¹ / ₄ " | 318.1 lb. |
| LM-EBNT-8-24 | 32 ⁵ / ₁₆ " (82.1 cm) | 4 ¹ / ₁₆ " (10.3 cm) | 80 ³ / ₈ " | 11 ¹ / ₂ " | 32" | 24" | 7 ¹ / ₄ " | 2 ¹ / ₄ " | 429.4 lb. |
| LM-EBNT-8-30 | 32 ⁵ / ₁₆ " (82.1 cm) | 4 ¹ / ₁₆ " (10.3 cm) | 80 ³ / ₈ " | 11 ¹ / ₂ " | 38" | 30" | 7 ¹ / ₄ " | 2 ¹ / ₄ " | 444.3 lb. |
| LM-EBNT-8-36 | 32 ⁵ / ₁₆ " (82.1 cm) | 4 ¹ / ₁₆ " (10.3 cm) | 80 ³ / ₈ " | 11 ¹ / ₂ " | 44" | 36" | 7 ¹ / ₄ " | 2 ¹ / ₄ " | 458.9 lb. |

FIG. 5A: LMS-EBT-46-4 Exploded Parts Diagram & Bill of Materials

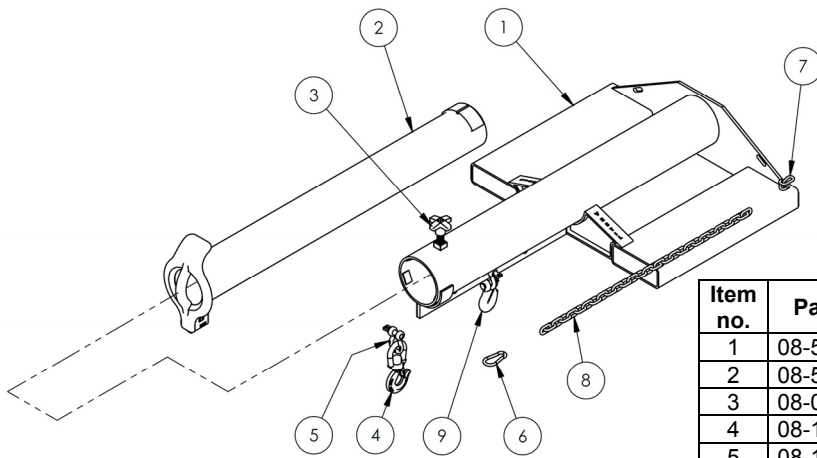

| Item no. | Part no. | Description | Quantity |
|----------|------------|------------------------------|----------|
| 1 | 08-514-268 | Weldment, frame, boom/base | 1 |
| 2 | 08-514-278 | Weldment, inner tube, shorty | 1 |
| 3 | 08-025-004 | X-handle, locking bolt | 1 |
| 4 | 08-145-001 | Swivel hook, 2-ton | 1 |
| 5 | 08-145-010 | 1/2" 2-ton shackle | 1 |
| 6 | 08-145-041 | 5/16" snap hook | 1 |
| 7 | 99-145-084 | Lap link | 1 |
| 8 | 99-145-037 | 5/16" chain 36" long | 1 |
| 9 | 99-645-019 | 2-ton hook and shackle | 1 |

FIG. 5B: LMS-EBT-46-6 Exploded Parts Diagram & Bill of Materials

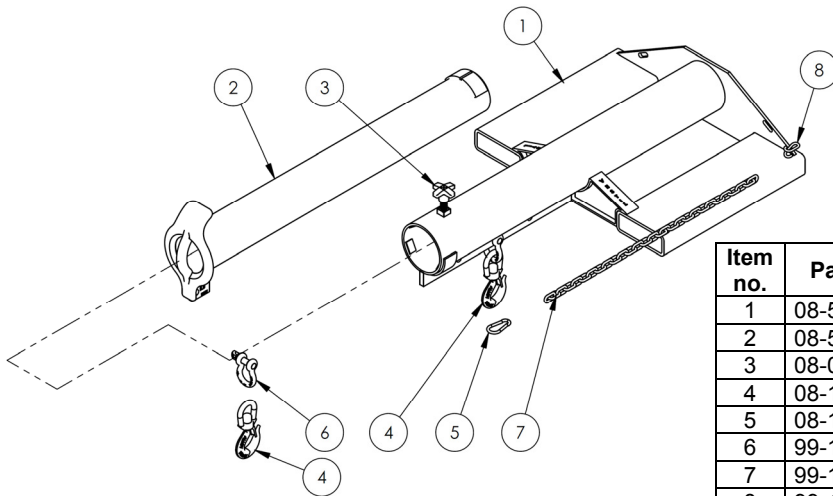

| Item no. | Part no. | Description | Quantity |
|----------|------------|------------------------------|----------|
| 1 | 08-514-270 | Weldment, frame, boom/base | 1 |
| 2 | 08-514-266 | Weldment, inner tube, shorty | 1 |
| 3 | 08-025-004 | X-handle, locking bolt | 1 |
| 4 | 08-145-002 | Swivel hook, 3-ton | 2 |
| 5 | 08-145-041 | 5/16" snap hook | 1 |
| 6 | 99-145-019 | 3 1/4-ton shackle, 5/8" | 2 |
| 7 | 99-145-037 | 5/16" chain 36" long | 1 |
| 8 | 99-145-084 | Lap link | 1 |

FIG. 5C: LMS-EBT-46-8 Exploded Parts Diagram & Bill of Materials

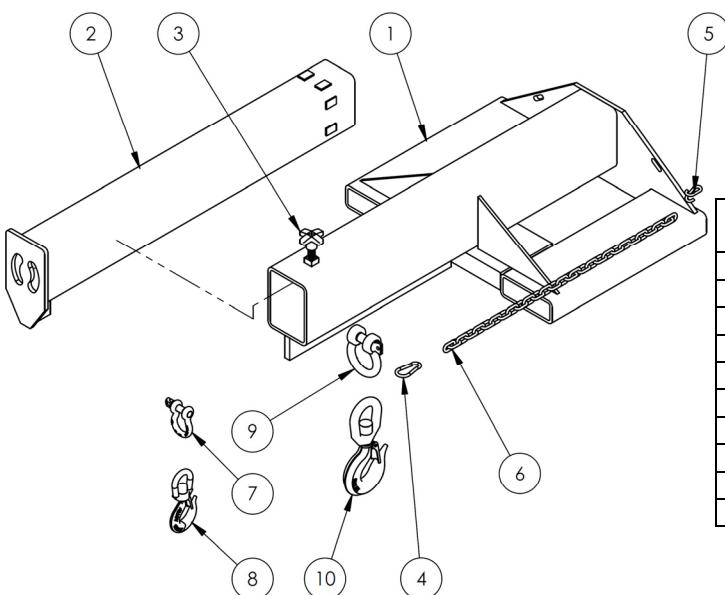

| Item no. | Part no. | Description | Quantity |
|----------|------------|------------------------------|----------|
| 1 | 08-514-277 | Weldment, frame, boom/base | 1 |
| 2 | 08-514-275 | Weldment, inner tube, shorty | 1 |
| 3 | 08-025-004 | X-handle, locking bolt | 1 |
| 4 | 08-145-041 | 5/16" snap hook | 1 |
| 5 | 99-145-084 | Lap link | 1 |
| 6 | 99-145-037 | 5/16" chain 36" long | 1 |
| 7 | 99-145-019 | 5/8" 3 1/4-ton shackle | 1 |
| 8 | 08-145-002 | Swivel hook, 3-ton | 1 |
| 9 | 08-145-006 | 1/8" 6 1/2-ton shackle | 1 |
| 10 | 08-145-005 | Swivel hook, 5-ton | 1 |

FIG. 5D: LMS-EBT-4k, 6k & 8k Centers of Gravity and Maximum Load Ratings for Varying Load Attachment Points

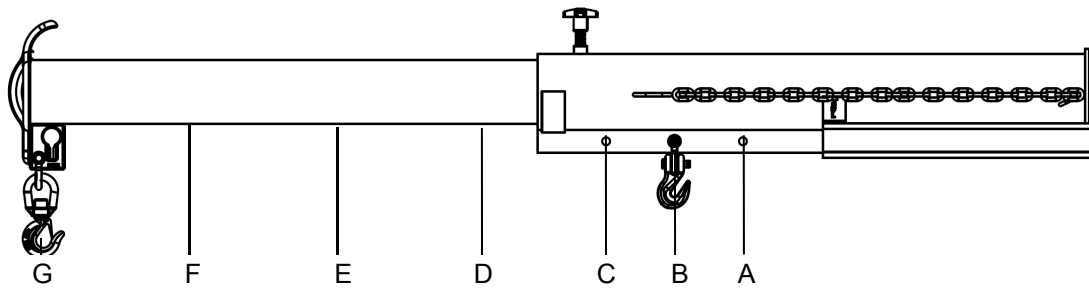

| Hook position | A | B | C | D | E | F | G |
|---|-----------------------|----------------------|----------------------|---|----------------------|---|---|
| Distance from end of boom | 31" (79cm) | 37" (94cm) | 43" (109cm) | 52 ³ / ₄ " (134cm) | 66" (168cm) | 79 ¹ / ₄ " (201cm) | 92 ³ / ₄ " (236cm) |
| Maximum rated load of a load suspended from a <i>single</i> hook located at the corresponding "Hook position". | | | | | | | |
| LMS-EBT-46-4 | 4000 lb. (1820kg) | 3880 lb. (1763kg) | 3760 lb. (1709kg) | 3560 lb. (1618kg) | 3290 lb. (1495kg) | 3020 lb. (1372kg) | 2750 lb. (1250kg) |
| LMS-EBT-46-4 | 6000 lb. (2727kg) | 5710 lb. (2595kg) | 5420 lb. (2463kg) | 4945 lb. (2247kg) | 4300 lb. (1954kg) | 3650 lb. (1659kg) | 3000 lb. (1364kg) |
| Distance from end of boom | 31" (79cm) | 37" (94cm) | 43" (109cm) | 52" (134cm) | 64" (168cm) | 76 ¹ / ₂ " (201cm) | 89" (236cm) |
| LMS-EBT-46-8 | 8000 lb. (3636 kg) | 7600 lb. (3454kg) | 7200 lb. (3272kg) | 6610 lb. (3004kg) | 5825 lb. (2647kg) | 5010 lb. (2277kg) | 4200 lb. (1909kg) |

The center of gravity of the boom changes as boom length changes. As shown in the diagram below, the horizontal center of gravity may be located at any point from RHCG to EHCG:

- **Retracted horizontal center of gravity (RHCG):** boom fully *retracted*, and load attached at position A. RHCG is measured from the "origin point" of the above diagram (edges of the fork pockets);
- **Extended horizontal center of gravity (EHCG):** boom fully *extended* with a load attached at position J. EHCG is also measured from the "origin point" of the above diagram (edges of the fork pockets);
- All other combinations of boom extension and load position produce a horizontal center of gravity located somewhere between RHCG and EHCG.

FIG. 5E: LMS-46 centers of gravity and dimensions

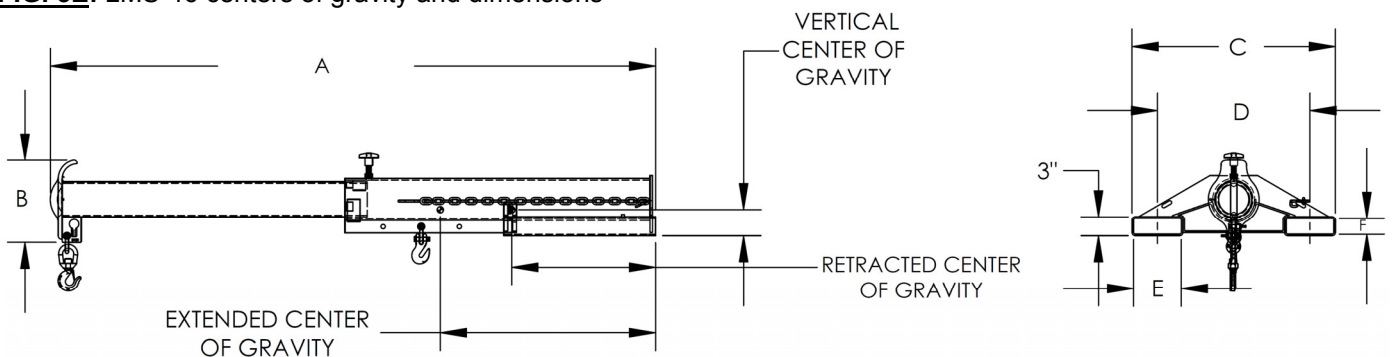

| Model | Extended horizontal center of gravity | Retracted horizontal center of gravity | Vertical center of gravity | A | B | C | D | E | F | Net weight |
|--------------|---|--|---|--|----------------------------------|-----|-----|---------------------------------|---------------------------------|------------|
| LMS-EBT-46-4 | 33 ⁷ / ₈ " (86.0 cm) | 22 ⁵ / ₈ " (57.5 cm) | 4 ¹ / ₈ " (10.5 cm) | 55 ¹ / ₄ -95 ¹ / ₄ " | 13" | 32" | 24" | 7 ¹ / ₂ " | 2 ¹ / ₂ " | 267.2 lb. |
| LMS-EBT-46-6 | 31 ⁷ / ₁₆ " (79.9 cm) | 21 ³ / ₈ " (54.3 cm) | 3 ⁷ / ₈ " (9.8 cm) | 55 ¹ / ₄ -95 ¹ / ₄ " | 13" | 32" | 24" | 7 ¹ / ₄ " | 2 ¹ / ₄ " | 302.5 lb. |
| LMS-EBT-46-8 | 34 ¹ / ₁₆ " (86.5 cm) | 22 ³ / ₄ " (57.8 cm) | 4 ³ / ₈ " (11.1 cm) | 53 ⁷ / ₈ -90 ⁷ / ₈ " | 11 ¹ / ₂ " | 32" | 24" | 7 ¹ / ₄ " | 2 ¹ / ₄ " | 442.3 lb. |

FIG. 5F: LMS-EBNT-40-4 Exploded Parts Diagram & Bill of Materials

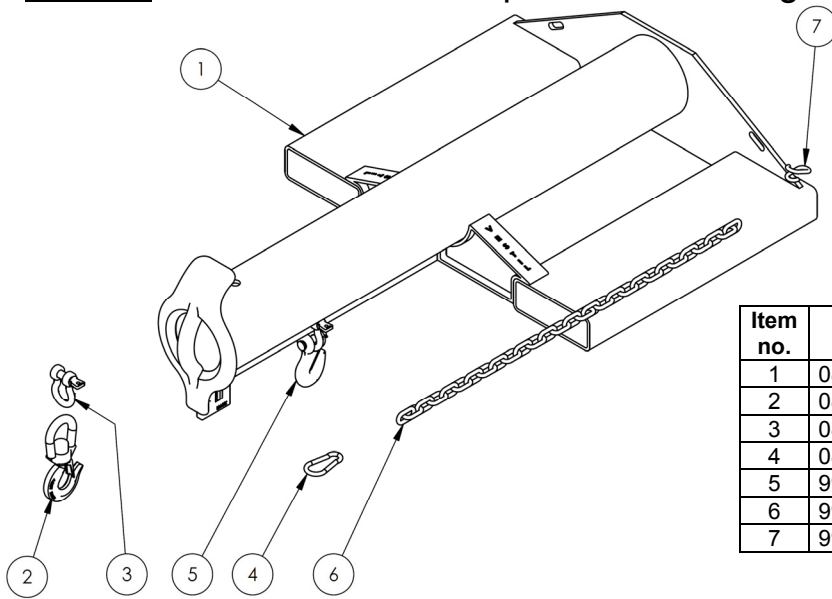

| Item no. | Part no. | Description | Quantity |
|----------|------------|----------------------------|----------|
| 1 | 08-514-196 | Weldment, frame, boom/base | 1 |
| 2 | 08-145-001 | Swivel hook, 2-ton | 1 |
| 3 | 08-145-010 | 1/2" 2-ton shackle | 1 |
| 4 | 08-145-041 | 5/16" snap hook | 1 |
| 5 | 99-645-019 | 2-ton hook and shackle | 1 |
| 6 | 99-145-037 | 5/16" chain 36" long | 1 |
| 7 | 99-145-084 | Lap link | 1 |

FIG. 5G: LMS-EBNT-40-6 Exploded Parts Diagram & Bill of Materials

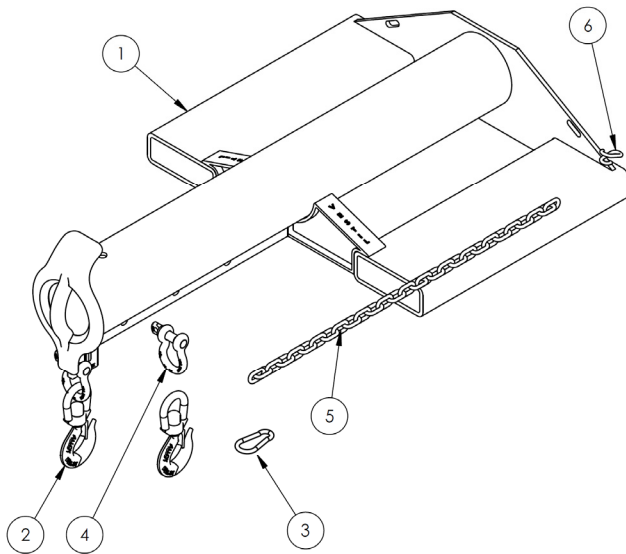

| Item no. | Part no. | Description | Quantity |
|----------|------------|----------------------------|----------|
| 7 | 08-145-001 | Swivel hook, 2-ton | 1 |
| 8 | 08-145-010 | 1/2" 2-ton shackle | 2 |
| 1 | 08-514-197 | Weldment, frame, boom/base | 1 |
| 2 | 08-145-002 | Swivel hook, 3-ton | 1 |
| 3 | 08-145-041 | 5/16" snap hook | 1 |
| 4 | 99-145-019 | 3 1/4-ton shackle, 5/8" | 2 |
| 5 | 99-145-037 | 5/16" chain 36" long | 1 |
| 6 | 99-145-084 | Lap link | 1 |

FIG. 5H: LMS-EBNT-40-8 Exploded Parts Diagram & Bill of Materials

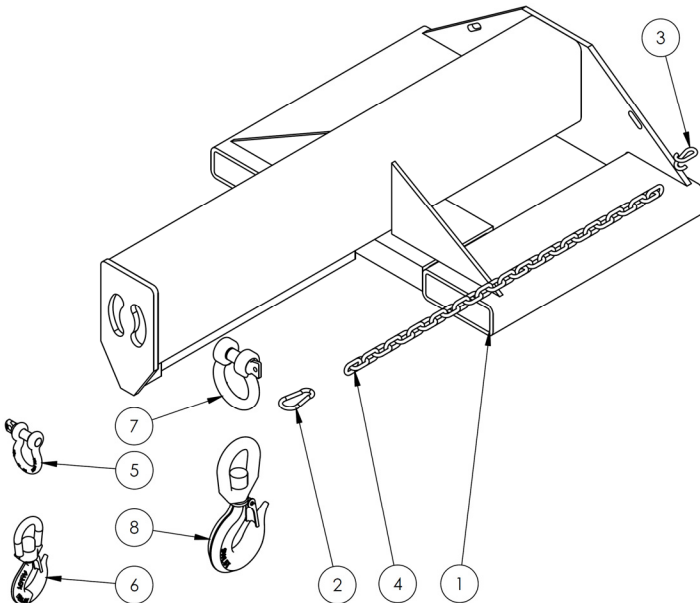

| Item no. | Part no. | Description | Quantity |
|----------|------------|---------------------------------|----------|
| 1 | 08-514-203 | Weldment, frame, boom/base | 1 |
| 2 | 08-145-041 | 5/16" snap hook | 1 |
| 3 | 99-145-084 | Lap link | 1 |
| 4 | 99-145-037 | 5/16" chain 36" long | 1 |
| 5 | 99-645-019 | 5/8" 3 1/4-ton hook and shackle | 1 |
| 6 | 08-145-002 | Swivel hook, 3-ton | 1 |
| 7 | 08-145-006 | 1/8" 6 1/2-ton shackle | 1 |
| 8 | 08-145-005 | Swivel hook, 5-ton | 1 |

FIG. 5J: LMS-EBNT-40-4k, 6k & 8k Centers of Gravity and Maximum Load Ratings for Varying Load Attachment Points

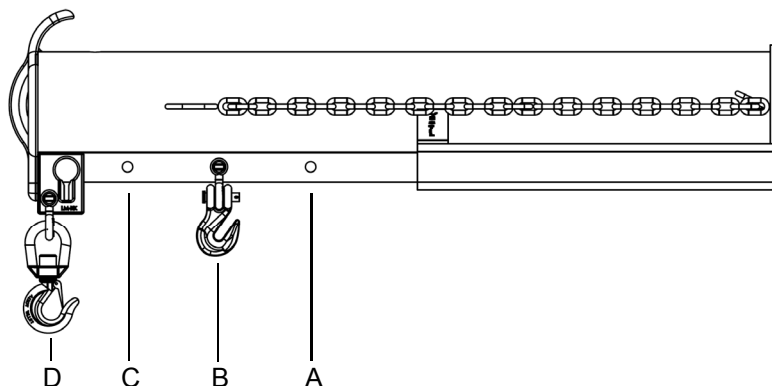

| Hook position | A | B | C | D |
|---|----------------------|----------------------|----------------------|---|
| Distance from end of boom | 31" (79cm) | 37" (94cm) | 43" (109cm) | 48 ¹ / ₈ " (122cm) |
| Maximum rated load of a load suspended from a <i>single</i> hook located at the corresponding "Hook position". | | | | |
| LMS-EBNT-46-4 | 4000 lb. (1820kg) | 3915 lb. (1779kg) | 3830 lb. (1740kg) | 3750 lb. (1705kg) |
| LMS-EBNT-46-4 | 6000 lb. (2727kg) | 5650 lb. (2568kg) | 5300 lb. (2409kg) | 5000 lb. (2045kg) |
| Distance from end of boom | 31" (79cm) | 37" (94cm) | 43" (109cm) | 47 ¹ / ₂ " (122cm) |
| LMS-EBNT-46-8 | 8000 lb. (3636kg) | 7275 lb. (3306kg) | 6550 lb. (2977kg) | 6000 lb. (3023kg) |

Center of gravity has both a horizontal component and a vertical component. The *vertical* center of gravity (VCG) lies along a line parallel to the bottom edges of the fork pockets. Similarly, the *horizontal* center of gravity (HCG) lies along a vertical line from the outer edges of the fork pockets.

FIG. 5K: LMS-EBNT centers of gravity and dimensions

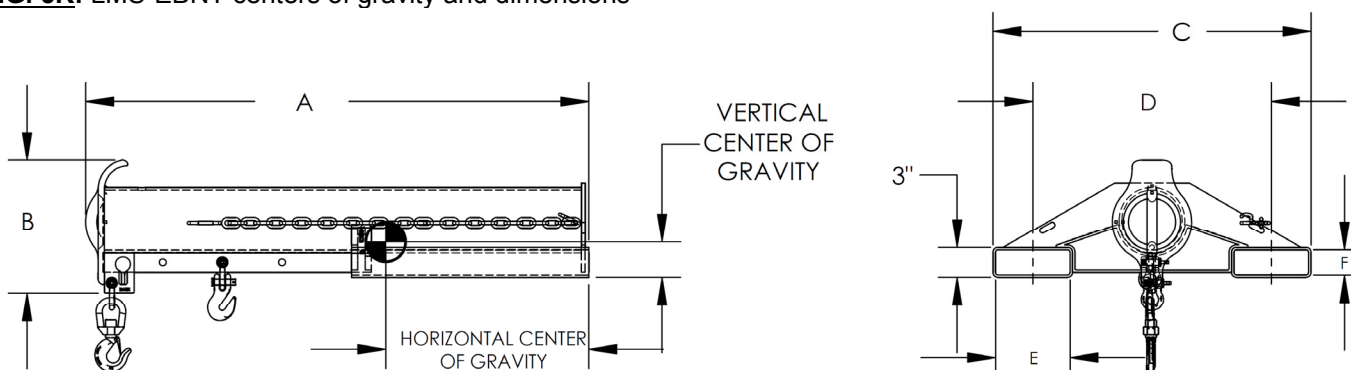

| Model | Horizontal center of gravity | Vertical center of gravity | A | B | C | D | E | F | Net weight |
|---------------|---|---|----------------------------------|-----------------------------------|-----|-----|---------------------------------|---------------------------------|------------|
| LMS-EBNT-40-4 | 20 ⁷ / ₁₆ " (20.4 cm) | 3 ⁹ / ₁₆ " (9.0 cm) | 50 ³ / ₄ " | 13 ⁵ / ₁₆ " | 32" | 24" | 7 ¹ / ₂ " | 2 ¹ / ₂ " | 204 lb. |
| LMS-EBNT-40-6 | 19 ¹ / ₂ " (49.5 cm) | 3 ¹ / ₄ " (8.3 cm) | 50 ⁵ / ₈ " | 13 ⁵ / ₁₆ " | 32" | 24" | 7 ¹ / ₄ " | 2 ¹ / ₄ " | 239 lb. |
| LMS-EBNT-40-8 | 20 ⁵ / ₈ " (52.4 cm) | 3 ⁵ / ₈ " (9.2 cm) | 49 ³ / ₈ " | 11 ¹ / ₂ " | 32" | 24" | 7 ¹ / ₄ " | 2 ¹ / ₄ " | 329 lb. |

Loading and Use Instructions:

Periodically review the "Safe use recommendations" on p. 2.

1. Drive the forklift forward and insert the tines into the fork pockets. Drive as far forward as possible. Lower the forks completely. The drawings below demonstrate this step:

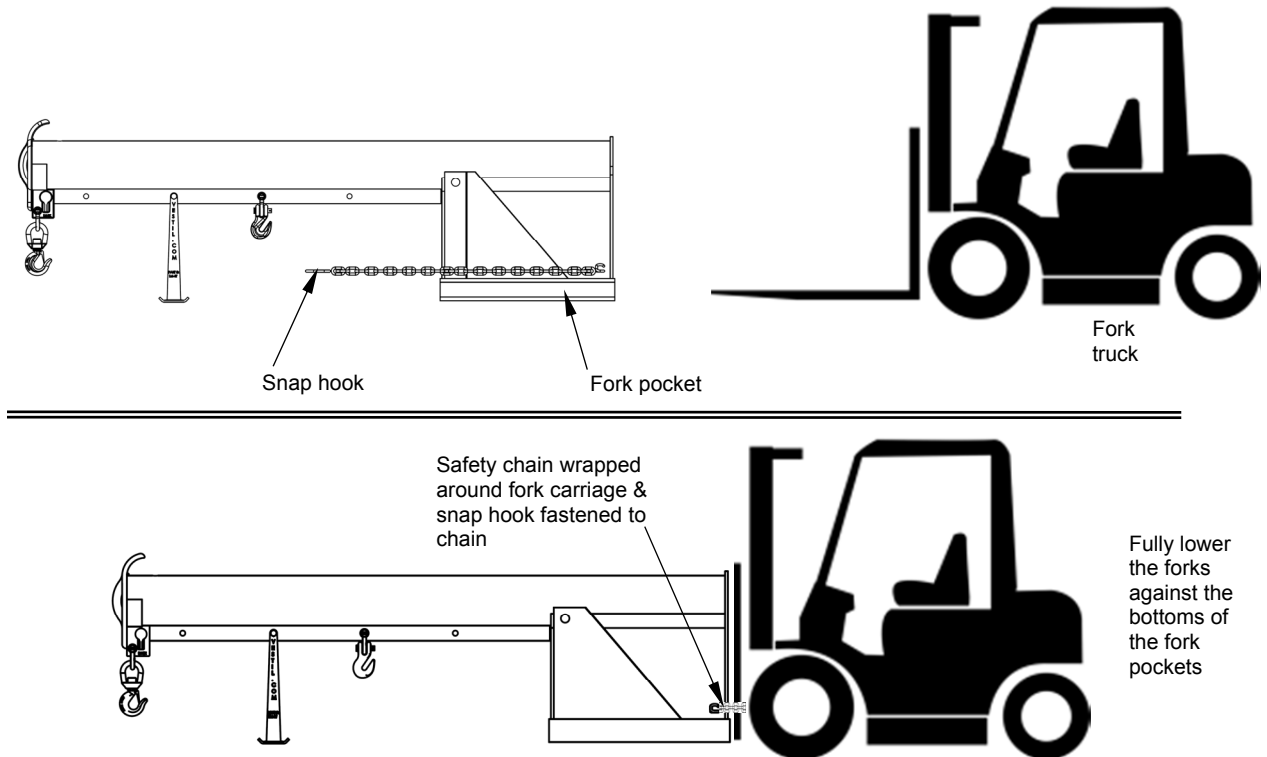

2. Securely connect the boom to the carriage of the forklift with the safety chain.

Wrap the safety chain around the fork carriage and fasten the snap hook to the chain/strap. There should be no slack in the chain/strap. The sole purpose of the safety chain is to prevent the boom from sliding off of the forks. It is NOT intended or designed to bear the full load rating.

3. **[Telescoping models only]** Adjust the boom length:

- a. Loosen the X-handle locking bolt ("locking bolt"), by turning it counterclockwise.
- b. Grasp the adjustment handle at the end of the boom and pull the boom to the desired length.
- c. Tighten the locking bolt by turning it clockwise.

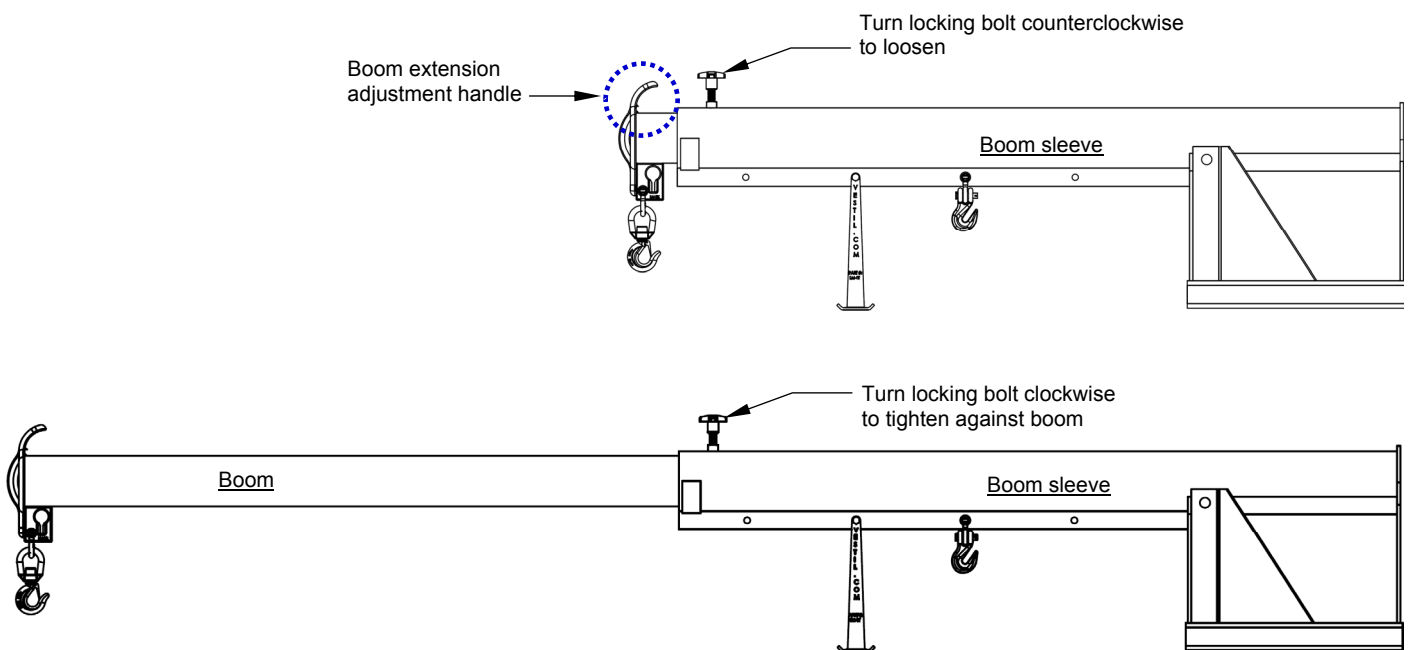

4. **[OBT models only]** Adjust the boom angle, if necessary, to accommodate the load. To safely perform the adjustment process requires *at least* 2 people:
- Person 1 grasps the (red) angle adjustment handle with one hand
 - While Person 2 pulls out the locking pin; then
 - Both 1 & 2 press down on the adjustment handle until the desired angle is achieved.
 - One of the participants reinserts the locking pin.

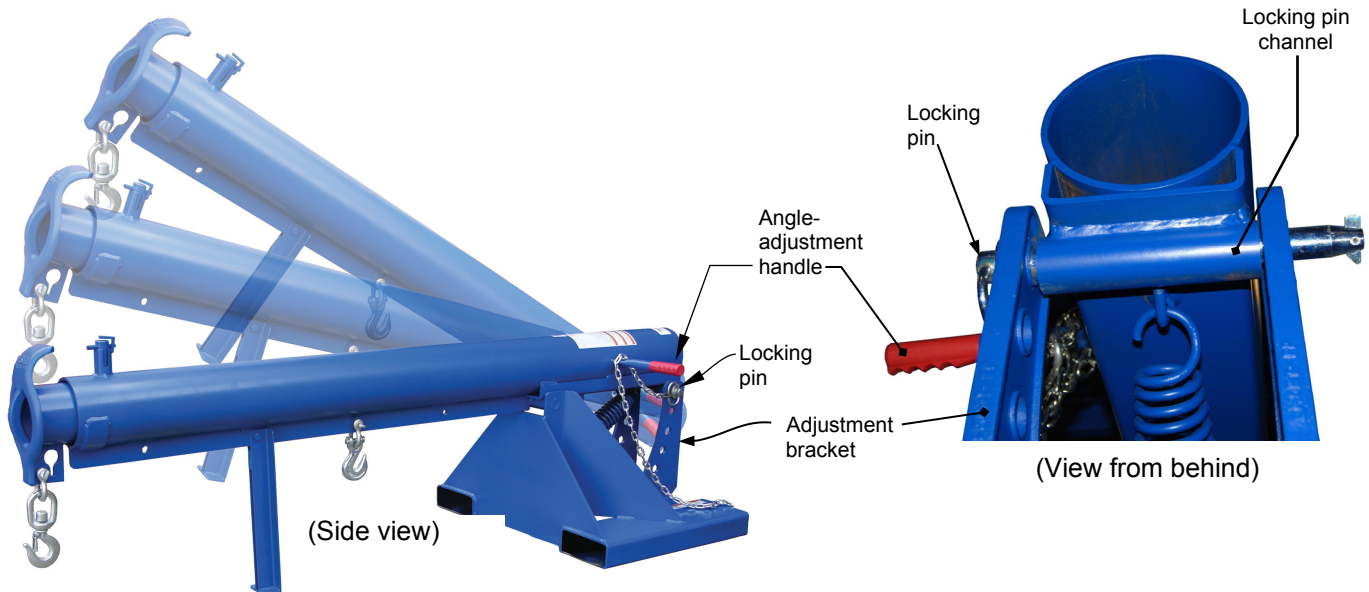

WARNING Material handling is dangerous. Improper use of this product might result in serious personal injuries.

- Confirm that the load weighs less than the maximum rated load of your boom AND that your fork lift is rated to lift the combined weight of the boom and the load.
- Contact the manufacturer of your fork lift BEFORE using the boom. Request that the lift manufacturer provide:
 1. Written approval to use the boom with your lift truck; AND
 2. Markings (labels) for the lift truck that:
 - Identify your LM-boom; AND
 - Provide the approximate net weight of the forklift truck and boom at the maximum fork elevation with a laterally-centered load. [29 CFR 1910.178(a)(5)].
- DO NOT use the boom until the forklift manufacturer provides adjusted maximum rated load tags for your fork lift.
- DO NOT attempt to lift loads weighing more than the rated load of either the boom or lift truck, **whichever is smaller**. Maximum rated load information appears in the tables on pages 4, 6, 8, 10, 12, 14, 16, 18, 20, and 22.
- Strictly adhere to all rules applied at your worksite regarding forklift operation, fork attachment usage, and load rigging.
- ONLY use rigging having maximum load ratings that exceed the load weight.
- DO NOT connect a load to only 1 hook, which will cause the load to rotate during lifting and transport operations. Loads should connect to both hooks simultaneously.

Load attached to only one hook (circled): load likely to rotate

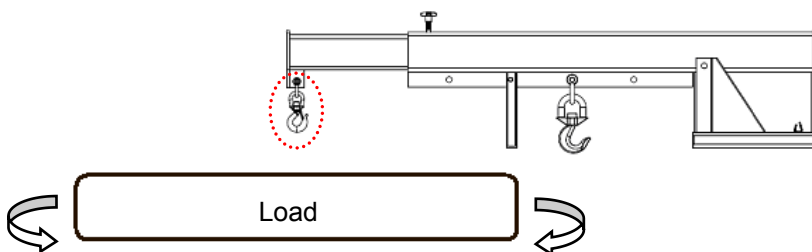

Load attached to both hooks: load rotation minimized

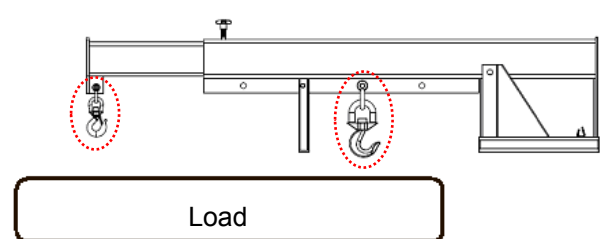

Test the stability of the load in the rigging. Raise the forks *slowly* to minimize load movement. Raise the forks until the load is entirely suspended from the boom. Watch the load and boom closely for *either* of the following issues: 1) Load sliding in rigging; or 2) Boom sliding towards tips of forks. If you notice either issue, immediately lower the forks and adjust the rigging. Retest the stability of the load in the rigging

- While transporting a load with the boom, the load should only be 6-8 inches above the ground. Adjust load height to avoid obstacles along the travel path.
- DO NOT exceed approximately 1.5mph (2.4kph) while transporting a load with the boom.
- Travel ONLY on smooth, level surfaces. Turn slowly and smoothly.
- If the load is unstable while suspended, DO NOT use the boom.

5. Attach the load to the boom by connecting the load to appropriate rigging. Attach the rigging to the end hook or to both the end hook and the stabilizing hook (see diagram below).

- Verify that the load attachment is stable;
- Raise the load until it is elevated no more than 6-8 inches above the ground (entirely suspended from the boom).
- Slowly transport the load to the desired unloading location;
- Slowly lower the load until it is entirely supported by the ground and there is slack in all rigging.
- Disconnect the rigging from the hooks;
- Adjust the fork position until no more than 6-8 inches above the ground;
- Return the boom to its storage location.

NOTE: Return OBT and OBNT model booms to the fully lowered (horizontal) position by reversing Step 4 on p. 24 BEFORE backing out of the fork pockets.

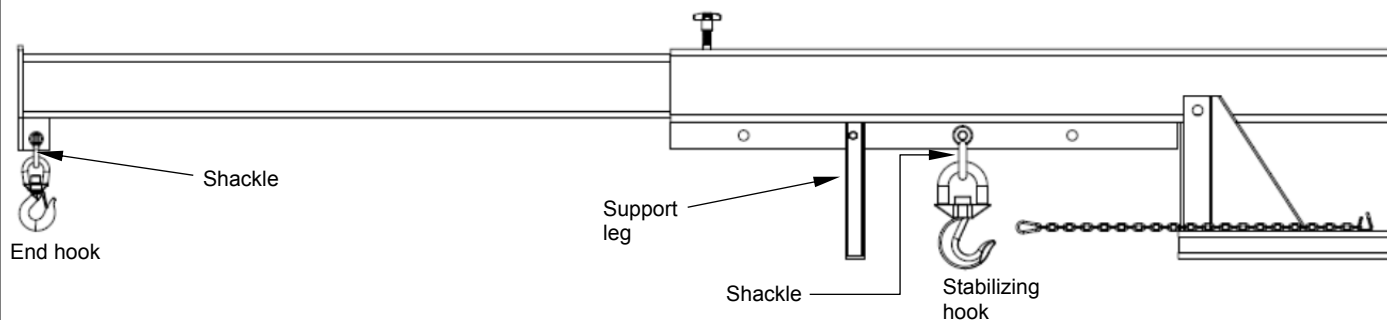

Inspections:

⚠WARNING Immobilize the boom before conducting inspections and performing maintenance. **If an inspection reveals problems, restore the boom to normal operating condition BEFORE using it again.** DO NOT use a boom that is structurally damaged in any way. Structural damage includes, but is not limited to, cracked welds, warping or deformation of the fork pockets, support leg, frame members, boom, or boom sleeve.

Inspect the boom regularly. An example of an inspection procedure appears in

1. Regular inspection — before using the boom (including its first use) inspect the following components for conditions that might interfere with normal operation:

- Frame and fork pockets: fork pockets should be square and solid. Each pocket should be rigidly welded to the frame. Excessive wear or damage (or indications of metal fatigue) to any portion of the fork pockets, support frame, boom or boom sleeve.
- Boom: check all welds. The boom should be straight and undamaged, i.e. no cracks, punctures, warps, etc. Telescoping models should slide without binding inside the receiver/sleeve.
- Safety chain: all links of the chain should be intact and of equal dimensions. The chains should be securely attached to the frame by means of a lap link. The snap hook at the end of the chain should close completely and automatically.
- Hooks and shackles: examine both the end hook and the stabilizing hook. Record the measurement of the throat opening of each hook and compare the measurements with those taken during the very first inspection. Replace a hook if its throat opening is more than 15 percent wider than the original throat opening measurement, or if the hook is twisted more than 10° from the plane of the unbent hook. Discard the damaged hook. The latch of the end hook should close automatically. Shackles should be securely attached to the underside of the boom. Examine all pins that attach shackles to the boom for cracks and warps.
- Locking bolt (telescoping models only): confirm that the locking bolt securely engages the top of the boom.
- Support leg: inspect the support leg. It should be straight, undamaged (no cracks or deformations), and securely attached to the underside of the boom.

- Labels: the product should always be labeled as shown in the labeling diagram on p. 27. Replace any label that is damaged, significantly faded, or not easily readable from a reasonable distance.

2. Annual performance evaluation: At least once per year, authorized personnel should lift a maximum rated load with the boom. Afterwards, conduct a "Prior-to-use inspection". Confirm that the product is in normal operating condition before returning it to service.

Maintenance:

Implement a maintenance program to ensure that the boom remains in normal operating condition. The following steps should be utilized in conjunction with maintenance procedures applicable to fork truck attachments provided in the most recent edition of ANSI B56.1.

Step 1: Tag the boom, "Out of Service."

Step 2: Remove dirt and other matter from all surfaces.

Step 3: Conduct a "Prior-to-use" inspection (see p. 25). If severe deformities, corrosion, rusting, or excessive wear of structural members is found, DO NOT use the product.

Step 4: Perform all necessary adjustments, replacements and/or repairs but DO NOT modify the boom.

⚠WARNING DO NOT return the boom to service until all necessary adjustments and repairs are complete! There is a significant difference between necessary adjustments and repairs, and modifications. An "adjustment" is a simple correction that restores the boom to normal operating condition, such as tightening loose fasteners or removing dirt or other debris from surfaces. Repair means removal of worn parts and installing replacement parts.

A "modification" is a change that alters the boom from original operating condition, like bending the structural members or removing parts. **NEVER** modify the boom without the express, written approval of Vestil. Modifications might make the boom unsafe to use and automatically void the Limited Warranty.

Step 5: Make a dated record of all repairs, adjustments, and replacements performed.

Labeling diagram:

Each boom should be labeled as shown below. Replace any label that is damaged or not easily readable.

One of labels 928-935 as indicated in the table (on either fork pocket)

⚠ WARNING

Material handling is inherently dangerous; improper use of this product might result in serious personal injuries sustained by the operator and/or bystanders. To reduce the risks:

- DO NOT use if safety chain/strap is damaged or absent.
- Law requires you to contact manufacturer of your (fork) lift truck BEFORE using boom to request:
 1. Written approval to use boom with lift truck [29 CFR 1910.178(a)(4)];
 2. Markings (labels) for lift truck that:
 - Identify this fork-mounted boom; AND
 - Give approximate net weight of truck and boom at maximum fork elevation with laterally-centered load.
- DO NOT use boom UNTIL lift truck manufacturer provides corrected maximum rated load tags for your forklift truck.
- DO NOT attempt to lift more than the rated load of the boom or lift truck, whichever is smaller. The table below shows the maximum rated load of the BOOM ONLY; you MUST compare the appropriate table entry with the corrected max. rated load label provided by the fork truck manufacturer.

⚠ ADVERTENCIA

La manipulación de materiales es inherentemente peligrosa; uso impropio de este producto podría resultar en daños personales serios al operador y/o a los espectadores. Para reducir los riesgos:

- NO use si la cadena/correa de seguridad está dañada o ausente
- No ley requiere que se ponga en contacto con el fabricante de su (horquilla) camioneta elevadora ANTES de usar el auge para pedir:
 1. Aprobación por escrito para el uso del auge con la camioneta elevadora [29 CFR 1910.178(a)(4)];
 2. Marcas (etiquetas) para la camioneta elevadora que:
 - Identifiquen este auge de la horquilla montada; Y
 - Den peso neto aproximado del camion y el auge a una elevación de la horquilla máxima con la carga lateralmente centrada. [29 CFR 1910.178(a)(5)]
- NO use el auge HASTA que el fabricante de la camioneta elevadora le haya proveído con las etiquetas de la correcta carga máxima tasada para su camioneta elevadora.
- NO intente elevar más de la carga tasada del auge o camioneta elevadora, lo que sea menor. La tabla a continuación del ensaña la máxima carga tasada para EL AUJE SOLO, DEBE comparar la tabla con la correcta carga máxima tasada de la etiqueta que el fabricante le ha proveído.

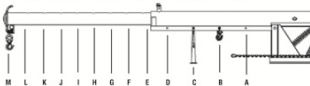

| | | |
|--------------------------------|-----------|-----------------|
| Weight of LM-boom by model: | LM-OBT-4k | 405 (-184 kg) |
| (Peso del LM-Auge por modelo): | LM-OBT-6k | 456 (-207.3 kg) |
| | LM-OBT-8k | 622 (-283 kg) |

| HOOK POSITION (Posición del gancho) | A | B | C | D | E | F | G | H | I | J | K | L | M |
|---|--------------|--------------|--------------|--------------|--------------|--------------|--------------|--------------|--------------|--------------|--------------|--------------|-------------|
| Distance from outer edge of fork pockets in inches (cm) (Distancia desde los extremos externos de los bolsillos de las horquillas en cm) | 36 (-91) | 48 (-122) | 60 (-152) | 72 (-183) | 84 (-213) | 91.5 (-232) | 99 (-251) | 106.5 (-271) | 114 (-290) | 121.5 (-309) | 129 (-328) | 136.5 (-347) | 144 (-366) |
| Maximum rated load in pounds (kg) of a load suspended from a single hook located at the corresponding "Hook position". (Máxima carga tasada en pounds (kg) de la carga suspendida desde un solo gancho localizado a la correspondiente posición del gancho.) | | | | | | | | | | | | | |
| LM-OBT-4k | 4000 (-1820) | 3750 (-1705) | 3500 (-1590) | 3250 (-1477) | 3000 (-1363) | 2845 (-1293) | 2690 (-1223) | 2450 (-1114) | 2375 (-1080) | 2220 (-1010) | 2060 (-936) | 1945 (-884) | 1750 (-795) |
| LM-OBT-6k | 6000 (-2727) | 5600 (-2527) | 4900 (-2245) | 4000 (-1820) | 3500 (-1591) | 3100 (-1410) | 2800 (-1273) | 2400 (-1091) | 2200 (-1000) | 2130 (-968) | 2000 (-909) | 1850 (-841) | 1650 (-750) |
| LM-OBT-8k | 8000 (-3636) | 6650 (-3022) | 6000 (-2727) | 5300 (-2409) | 4650 (-2113) | 4000 (-1820) | 3500 (-1590) | 3000 (-1363) | 2600 (-1181) | 2440 (-1109) | 2280 (-1036) | 2130 (-968) | 2000 (-909) |

| Label | Model |
|-------|----------|
| 928 | LM-OBT |
| 929 | LM-OBNT |
| 930 | LM-1T |
| 931 | LM-EBT |
| 932 | LM-HRT |
| 933 | LM-EBNT |
| 934 | LM-HRNT |
| 935 | LM-1NT |
| 962 | LMS-EBT |
| 963 | LMS-EBNT |

Label 287 (on either fork pocket)

MODEL/MODÉ LO/MODELE _____

CAPACITY _____ lbs.

CAPACIDAD/CAPACITÉ _____ kgs.

SERIAL/SERIE/SÉRIE _____

VESTIL MANUFACTURING CORPORATION 287

sales@vestil.com • www.vestil.com REV 03/02



Label 218 (on either fork pocket)

| ⚠ WARNING | ⚠ ADVERTENCIAS |
|--|--|
| <p>Improper use might result in death or serious personal injury. Attach device to fork carriage with safety chain/strap.</p> <ul style="list-style-type: none"> • Drive lift truck forward until forks contact ends of fork pockets. • Chain/straps must not be able to disconnect (slide free) from carriage. • Safety chain/strap must be taut. Connect chain/strap to carriage via shortest line. | <p>El uso impropio puede resultar en muerte o heridas personales. Atar aparato al mástil del montacargas con cadenas/correas.</p> <ul style="list-style-type: none"> • Maneje el montacargas para adelante hasta que las cuñas hagan contacto con la orilla del bolsillo de las cuñas. • La cadenas y correas no deben de deslizarse (soltarse) del mástil del montacargas. • La cadena/correa de seguridad debe de estar apretado. Asegure la cadena/correa al mástil via la ruta mas corta. |

LIMITED WARRANTY

Vestil Manufacturing Corporation ("Vestil") warrants this product to be free of defects in material and workmanship during the warranty period. *Our warranty obligation is to provide a replacement for a defective original part if the part is covered by the warranty, after we receive a proper request from the warrantee (you) for warranty service.*

Who may request service?

Only a warrantee may request service. *You are a warrantee if* you purchased the product from Vestil or from an authorized distributor AND Vestil has been fully paid.

What is an "original part"?

An original part is a part used to make the product as shipped to the warrantee.

What is a "proper request"?

A request for warranty service is proper if Vestil receives: 1) a photocopy of the Customer Invoice that displays the shipping date; AND 2) a written request for warranty service including your name and phone number. Send requests by any of the following methods:

| | | |
|---|--|------------------|
| <u>Mail</u> | <u>Fax</u> | <u>Email</u> |
| Vestil Manufacturing Corporation 2999 North Wayne Street, PO Box 507 Angola, IN 46703 | (260) 665-1339 <u>Phone</u> (260) 665-7586 | sales@vestil.com |

In the written request, list the parts believed to be defective and include the address where replacements should be delivered.

What is covered under the warranty?

After Vestil receives your request for warranty service, an authorized representative will contact you to determine whether your claim is covered by the warranty. Before providing warranty service, Vestil may require you to send the entire product, or just the defective part or parts, to its facility in Angola, IN. The warranty covers defects in the following *original* dynamic components: motors, hydraulic pumps, electronic controllers, switches and cylinders. It also covers defects in *original* parts that wear under normal usage conditions ("wearing parts"), such as bearings, hoses, wheels, seals, brushes, and batteries.

How long is the warranty period?

The warranty period for original dynamic components is 1 year. For wearing parts, the warranty period is 90 days. The warranty periods begin on the date when Vestil ships the product to the warrantee. If the product was purchased from an authorized distributor, the periods begin when the distributor ships the product. Vestil may, at its sole discretion, extend the warranty periods for products shipped from authorized distributors by *up to* 30 days to account for shipping time.

If a defective part is covered by the warranty, what will Vestil do to correct the problem?

Vestil will provide an appropriate replacement for any *covered* part. An authorized representative of Vestil will contact you to discuss your claim.

What is not covered by the warranty?

1. Labor;
2. Freight;
3. Occurrence of any of the following, which automatically voids the warranty:
 - Product misuse;
 - Negligent operation or repair;
 - Corrosion or use in corrosive environments;
 - Inadequate or improper maintenance;
 - Damage sustained during shipping;
 - Collisions or other incidental contacts causing damage to the product;
 - Unauthorized modifications: DO NOT modify the product IN ANY WAY without first receiving written authorization from Vestil. Modification(s) might make the product unsafe to use or might cause excessive and/or abnormal wear.

Do any other warranties apply to the product?

Vestil Manufacturing Corp. makes no other express warranties. All implied warranties are disclaimed to the extent allowed by law. Any implied warranty not disclaimed is limited in scope to the terms of this Limited Warranty.

